

Magnetic dirt separator SM 25 - DN 25

Destiny:

The separator is used to remove water contaminants in closed central heating systems, especially sand and rust particles. Contaminants in the circuit can accelerate the wear of the water pump, valves and other components of the heating system. Dirt can also block heat exchangers, radiator or pipe ends, reducing the efficiency of the entire system.

Due to its special design, the separator can be installed horizontally or vertically. It enables excellent filtration and deposition of pollutants in the filter tank. Removal of pollutants can occur during normal operation of the installation. The device can be mounted on vertical or horizontal, obliquely pipelines.



Technical Specifications:

- Body: glass fiber reinforced nylon
- Filter mesh made of plastic;
- 9000 G neodymium magnet;
- Medium: water;
- Temperature range (min-max) 0 ° C + 90 ° C;
- Max. inlet pressure - 4 bar;
- Max. flow 3.0 m³ / h;
- Connection: 1 "F x 1" F x 1 "F;
- Sealing: EPDM

Installation: on vertical, horizontal and diagonal pipelines.
The arrow on the body shows the direction of water flow.

Type	Catalog number
Magnetic dirt separator SM 20 - 3/4"	500035
Magnetic dirt separator SM 25 - 1"	500036

Dimensions and construction



1. Air vent
2. Filter body with magnet neodymium and filter
3. Drain valve
4. Inlet shut-off valve
5. Outlet shut-off valve
6. Dual-function assembly wrench
- intended for unscrewing body and position changes assembly

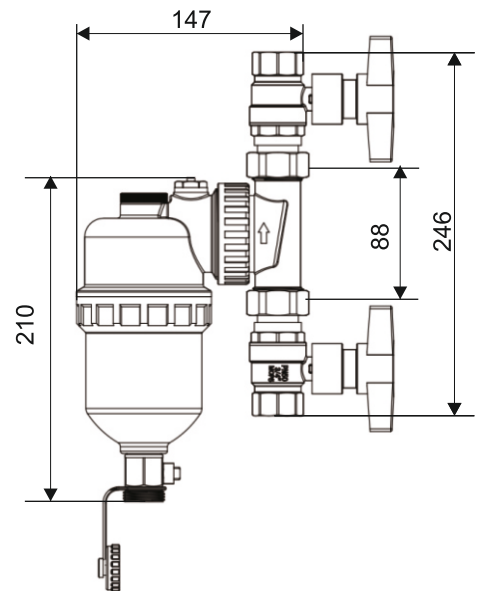

Installation:

Due to the special construction of the body, the separator can be installed horizontally, vertically or oblique. The dirt separator ensures perfect filtration. We can clean the filter during normal operation of the installation

- It is recommended to install a separator on the boiler return (installation on the boiler flow is allowed)
- We perform the first routine cleaning one month after the first installation. Then carry out cleaning twice a year when the heating system is turned on.
- The cleaning intervals must be adapted to the specifications of the system.

POSITIONS ASSEMBLY AND USE

- The filter should be installed under the boiler on the system return.
- Select the correct filter setting (recommended installation position A, permitted B).
- 1 "water connection.

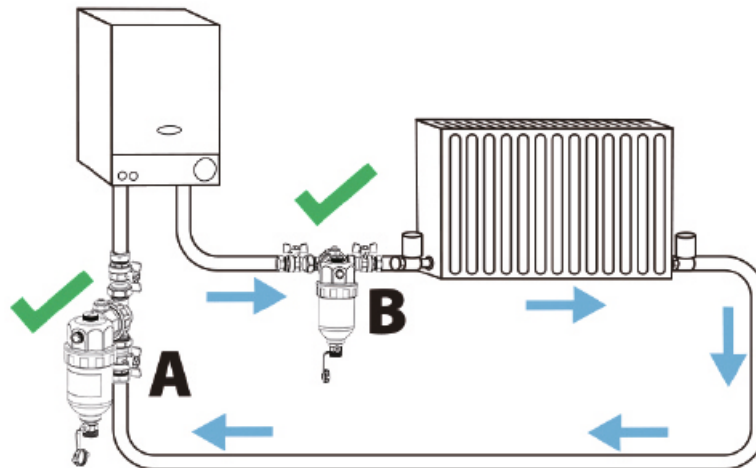

IMPORTANT: Before checking, cleaning, or servicing devices turn off the boiler, close shut-off valves upstream of the separator debris and wait for all parts to cool.

Inspection, cleaning and maintenance
We clean the device as follows:

1. Turn off the boiler, close the filter valves and the valve on the boiler feed.
2. Place a container under the filter. We wait for the water to cool down.
3. Unscrew the magnet and take it out from the filter socket. (Removal of the magnet allows any debris and magnetic deposits that will fall into the filter housing).
4. Then open the drain valve by turning its lever.
5. Wait a few seconds, then slightly open the shut-off valve to allow the flow to flow through washing water and rinsing out impurities
6. Then close the shut-off valve again.
7. We wash the filter thoroughly, remove sediments and deposits.
8. Before reassembly, lubricate the O-rings with silicone grease.
9. After cleaning, put the filter back together
10. Place the magnetic insert in the socket, and screw it on. We open the valves again.



ALWAYS REMOVE THE MAGNET WHEN DISASSEMBLING OR REASSEMBLY OF REST COMPONENTS

