

Flow heating tube HP 100 - DN 40

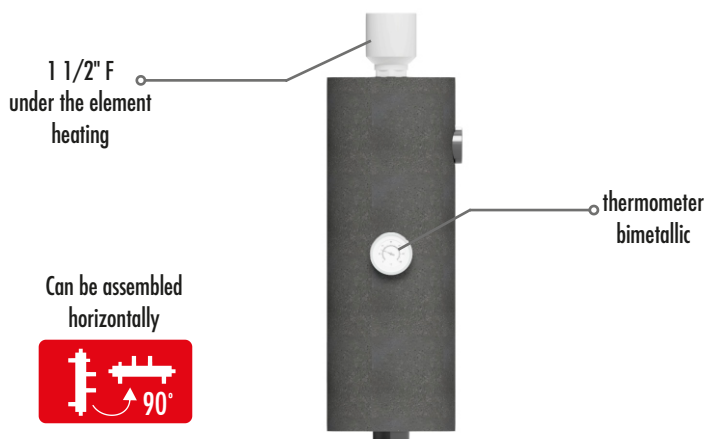

Flow heating tube HP 100 - DN 40 for heating systems is made of steel. The factory is equipped with EPP insulation and a thermometer. The flow heating tube HP 100 - DN 40 will work in systems powered by a heat pump or a fireplace as an additional source of heat. It can be used as a protection against freezing of the medium in the installations of summer houses or buildings used occasionally.

Technical data:

Material:	steel
Max pressure:	6 bar
Max temp.:	110°C
Insulation:	EPP black 60 g/l
Connections:	1 1/2" F
Electric heater thread required:	1 1/2" M

Attention! The product does not contain a heater. The maximum power of the heater is 6 kW.

Attention! To prevent damage to the heating element during operation, a constant flow of medium through the device must be ensured.

Type	Catalog number
Flow heating tube HP 100 - DN 40 with insulation,	609310

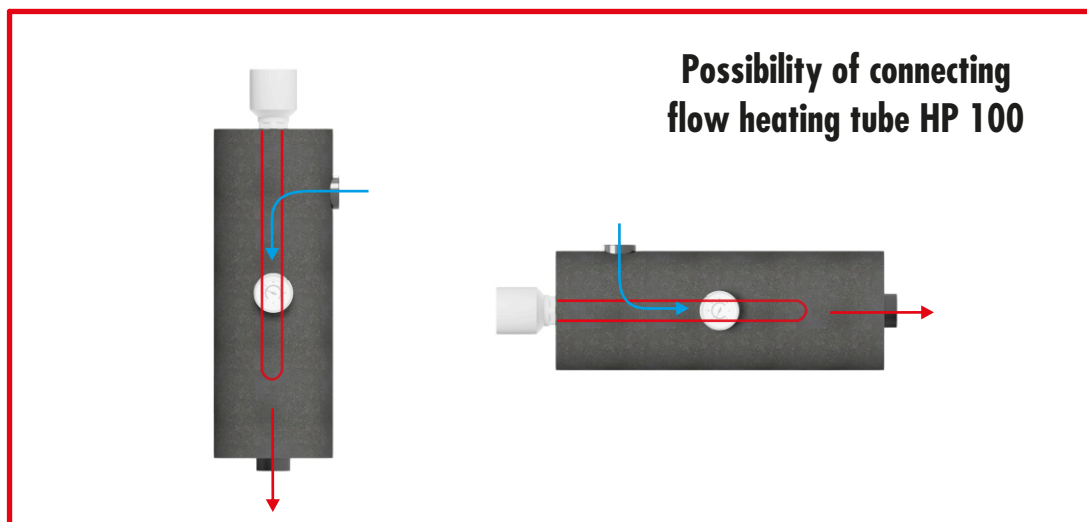

Flow heating tube HP 100 - DN 40 should only be used in central heating installations.



It is important that the pipe is filled with the heating medium before starting work.



The heating device should be installed in accordance with the manufacturer's instructions.



A circulation pump must be installed for the correct operation of the device.



Dimensional diagram flow heating tube

