

Catalog 2018

Energy - saving central heating equipment

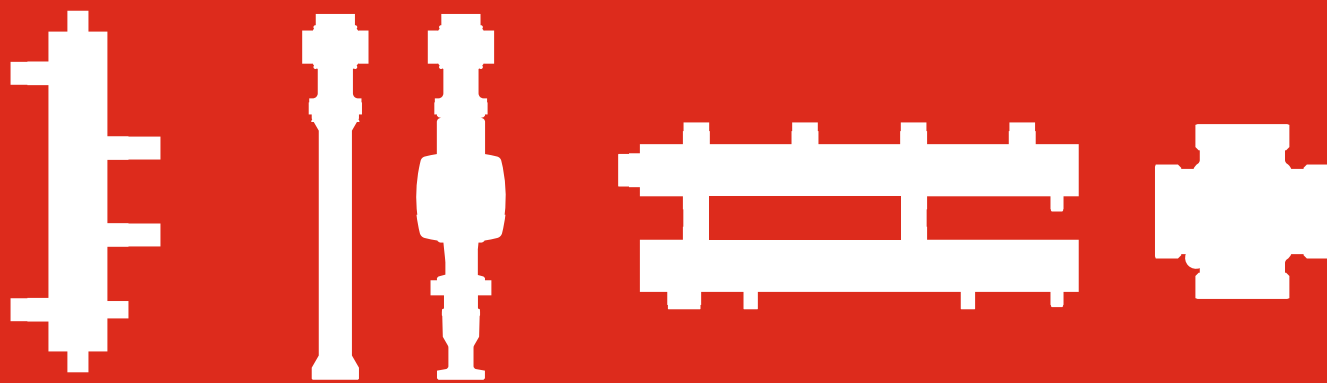

womix
Comfort Controls

CONTENTS



Mixing valves MIX M

3



System MIX-BOX

5



Systems with pump groups DN 25

11



Prepared set DN 25

25

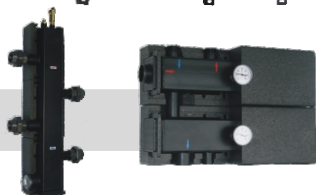

Systems with pump groups DN 32

29



Systems with pump groups DN 50

37



Actuators for mixing valves

39



Ball valves with filter Bioflux

42



Other products

43

Mixing valves MIX M

for the regulation of your heating circuits



- brass, threaded,
- double seal EPDM,
- visible, legible red scale,
- contoured handle,
- execution in diameter G 3/4" - 2"

MIXING VALVES - MIX M

Mixing valves MIX M



Mixing valves **MIX M** are used in central heating. Three-way mixing valve is used primarily to reduce the temperature of heating circuit such as floor heating systems. Four-way mixing valve in addition to temperature control circuit protects the boiler / heat source from a low return temperature. Fully automatic operation of the valve can be provided by the actuator from WOMIX like **MP 10**.

Box of mixing valve



Technical data:

Dimensions: from 3/4" to 2"
 Seal: two O-rings EPDM
 Body: brass CW617N
 Rotor and cap: brass CW617N
 Angle of rotation: 90°
 Max. pressure: 10 bar
 Max. temp.: 110° C
 Handle: red or blue plastic
 Scale: aluminum

Actuator: for dimensions 3/4" - 2" - **MP 10**
 (see page no. 39)

Dimensions:

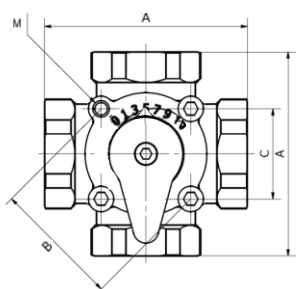
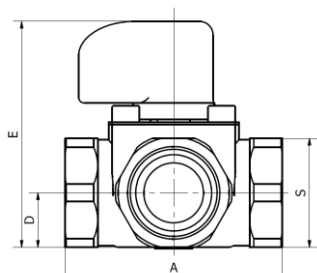

3-ways mixing valves

Type	Kv	Size	A	B	C	D	S	M	E	Cod.
MIX M 3 - 20	4	3/4"	74	50	35,4	18	32	6	80	601001
MIX M 3 - 20	6	3/4"	74	50	35,4	18	32	6	80	601002
MIX M 3 - 20	8	3/4"	74	50	35,4	18	32	6	80	601003
MIX M 3 - 25	8	1"	80	50	35,4	20	40	6	82	601004
MIX M 3 - 25	12	1"	80	50	35,4	20	40	6	82	601005
MIX M 3 - 32	12	1 1/4"	86	50	35,4	25	50	6	87	601006
MIX M 3 - 32	18	1 1/4"	86	50	35,4	25	50	6	87	601007
MIX M 3 - 40	28	1 1/2"	110	70	49,9	27	55	6	97	601008
MIX M 3 - 50	44	2"	120	70	49,5	27	70	6	107	601009

4-ways mixing valves

Type	Kv	Size	A	B	C	D	S	M	E	Cod.
MIX M 4 - 20	8	3/4"	74	50	35,4	18	32	6	80	602003
MIX M 4 - 25	8	1"	80	50	35,4	20	40	6	82	602004
MIX M 4 - 25	12	1"	80	50	35,4	20	40	6	82	602005
MIX M 4 - 32	12	1 1/4"	86	50	35,4	25	50	6	87	602006
MIX M 4 - 32	18	1 1/4"	86	50	35,4	25	50	6	87	602007
MIX M 4 - 40	28	1 1/2"	110	70	49,9	27	55	6	97	602008
MIX M 4 - 50	44	2"	120	70	49,5	27	70	6	107	602009

MIX M valve construction

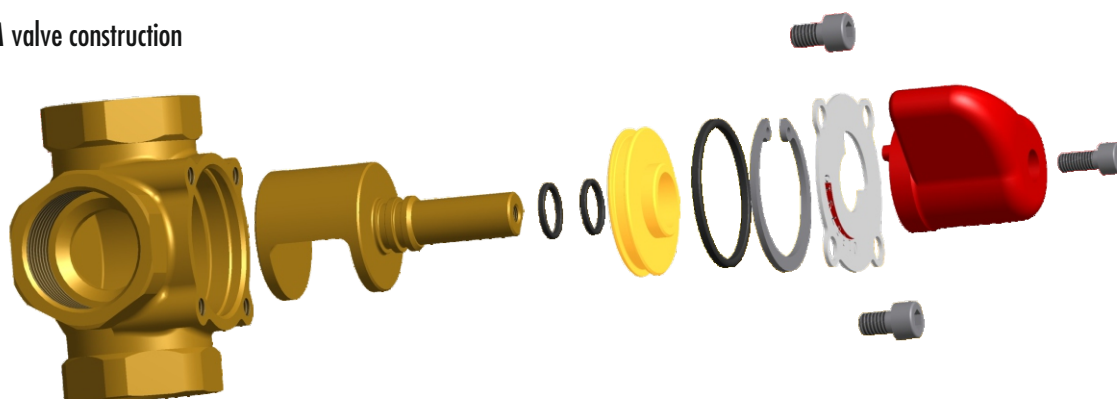

SYSTEM MIX - BOX DN 20 - System to power 30 kW
Perfect products for wall-hanging boilers

SYSTEM MIX-BOX

for 2 or 3 heating circuits

Perfect products for wall-hanging boilers



**System MIX-BOX
available with two
types of pumps**



**Wilo
Yonos Para RS**



**Grundfos
UPM3 AutoL**



System of power to 30 kW

The **MIX-BOX SYSTEM** is a complete distribution system of heating circuits in the installation with wall-hanging boiler, both standard and condensing. It can handle up to three heating circuits. The heating circuits may be pumping or mixing with rotary or thermostatic mixing valve. Pump group are equipped with pump **Wilo-type Yonos Para RS 15/6 RKA** (electronic) or **Grundfos UPM3 AUTOL 15 - 70** (electronic). The housing for **MIX-BOX** system is made in the wall version.

Technical data:

Zone manifold material:

Pump groups material:

Max temp.:

Max. work pressure:

Supply voltage pumps:

Working range temperature

for thermostatic mixing valve:

Length of pump:

Connection of the pump:

steel, insulation EPP black40 g/l

brass CW602N, copper

110°C

6 bar

230 VAC, 50 Hz

20 - 43°C.

130 mm

1" M



www.womix.pl

SYSTEM MIX - BOX DN 20 - System to power 30 kW

Perfect products for wall-hanging boilers

MIX-BOX 1

System of 2 heating circuits including one with a mixing valve and a rotary electric actuator



Type	Cod.
System MIX-BOX 1 with groups SA 83 and SMT 83 with pumps WILO Yonos Para RS 15/6 RKA	604102
System MIX-BOX 1 with groups SA 83 and SMT 83 with pumps GRUNDFOS UPM3 AUTO L 15 - 70	604121



The system contains:

1. Wall cabinet **P2** (art. nr: 604003), (see page no. 7)
2. Zone manifold **CX 2F** (art. nr: 604012), (see page no. 7)
3. Group **SA 83 MIX-BOX 20**, (see page no. 8)
4. Group **SMT 83 MIX-BOX 20**, (see page no. 8)

MIX-BOX 2

System of 2 heating circuits including one with thermostatic mixing valve



Type	Cod.
System MIX-BOX 2 with groups SA 83 and SMT 83 with pumps WILO Yonos Para RS 15/6 RKA	604104
System MIX-BOX 2 with groups SA 83 and SMT 83 with pumps GRUNDFOS UPM3 AUTO L 15 - 70	604123



The system contains:

1. Wall cabinet **P2** (art. nr: 604003), (see page no. 7)
2. Zone manifold **CX 2F** (art. nr: 604012), (see page no. 7)
3. Group **SA 83 MIX-BOX 20**, (see page no. 8)
4. Group **SMT 83 MIX-BOX 20**, (see page no. 8)

MIX-BOX 3

System of 2 heating circuits with a mixing valves and a rotary electric actuators



Type	Cod.
System MIX-BOX 3 with 2 groups SMT 83 with pumps WILO Yonos Para RS 15/6 RKA	604106
System MIX-BOX 3 with 2 groups SMT 83 with pumps GRUNDFOS UPM3 AUTO L 15 - 70	604125



The system contains:

1. Wall cabinet **P2** (art. nr: 604003), (see page no. 7)
2. Zone manifold **CX 2F** (art. nr: 604012), (see page no. 7)
3. Group **SMT 83 MIX-BOX 20**, (see page no. 8)
4. Group **SMT 83 MIX-BOX 20**, (see page no. 8)

MIX-BOX 4

System of 2 direct heating circuits without a mixing valves



Type	Cod.
System MIX-BOX 4 with 2 groups SA 83 with pumps WILO Yonos Para RS 15/6 RKA	604108
System MIX-BOX 4 with 2 groups SA 83 with pumps GRUNDFOS UPM3 AUTO L 15 - 70	604127



The system contains:

1. Wall cabinet **P2** (art. nr: 604003), (see page no. 7)
2. Zone manifold **CX 2F** (art. nr: 604012), (see page no. 7)
3. Group **SA 83 MIX-BOX 20**, (see page no. 8)
4. Group **SA 83 MIX-BOX 20**, (see page no. 8)

SYSTEM MIX - BOX DN 20 - System to power 30 kW

Perfect products for wall-hanging boilers

Cabinet mounting for the system **MIX-BOX** - wall-mounted version P

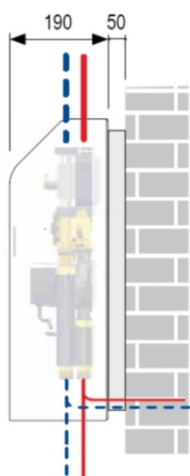

Type	Cod.
Wall-mounted cabinet P2 for 2 heating circuits	604003
Wall-mounted cabinet P3 for 3 heating circuits	604002

Galvanized plate material. Closing cabinet powder painted - white RAL 9010.
The dimensions of the cabinet **P2** for 2 heating circuits: **590x353x193** (height / width / depth).
The dimensions of the cabinet **P3** for 3 heating circuits: **590x490x193** (height / width / depth).

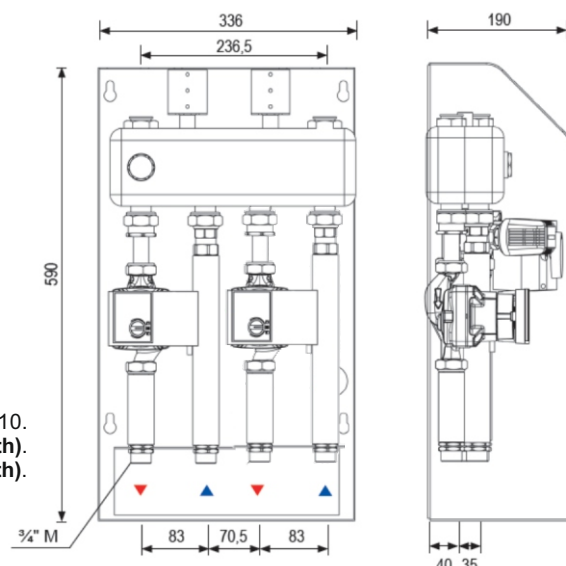

Zone manifold for 2- or 3-circuits **CX**



Zone manifold **CX** is made of black painted steel and insulated. It is equipped with mini-hydraulic separator, which by end cap can be opened (see picture).

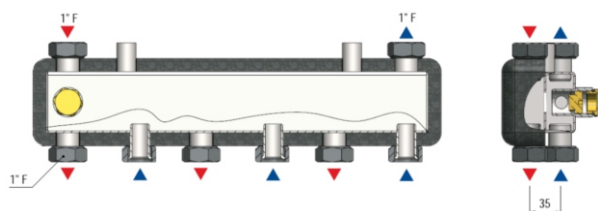

The MINI hydraulic separator
The flow diagram between supply and return.

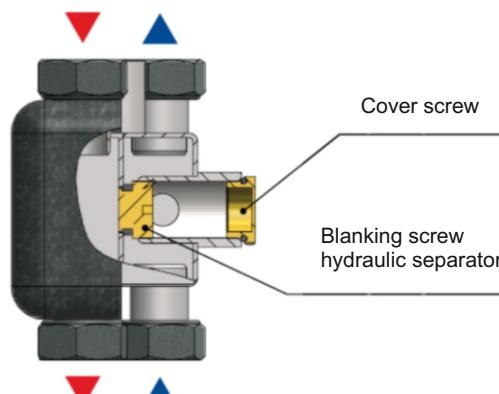
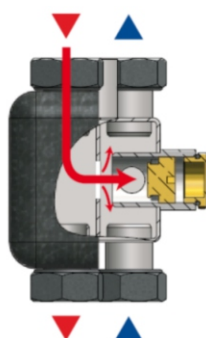
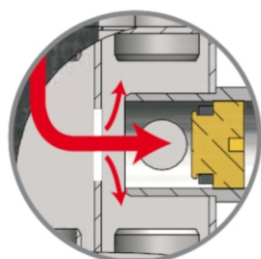

Type	Cod.
Zone manifold CX 2F for 2 heating circuits	604012
Zone manifold CX 3F for 3 heating circuits	604011



SYSTEM MIX - BOX DN 20 - System to power 30 kW

Perfect products for wall-hanging boilers

Pump group SA 83 MIX-BOX 20

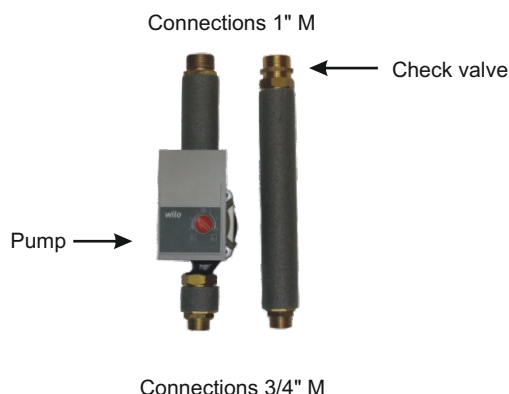

Pump group **SA 83 MIX-BOX 20** without mixing valve is equipped with a check valve, a set of insulated connecting pipes and a pump **Wilo** or **Grundfos**.

Type	Cod.
Pump group SA 83 MIX-BOX 20 with pump Wilo Yonos Para RS 15/6 RKA 130	604062
Pump group SA 83 MIX-BOX 20 with pump GRUNDFOS UPM3 AUTO L 15 - 70	604065



Pump group SMT 83 MIX-BOX 20

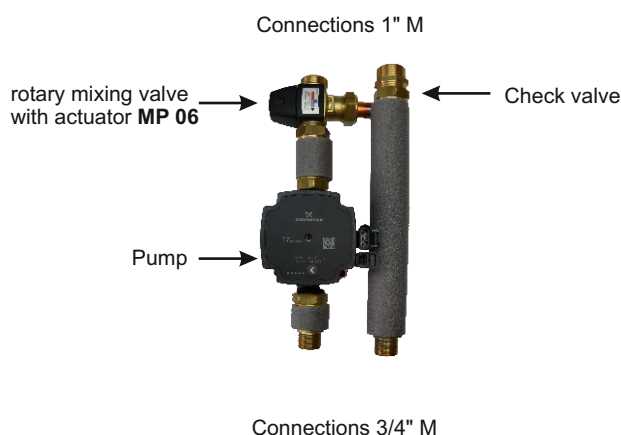

Pump group **SMT 83 MIX-BOX 20** is equipped with a 3-way rotary mixing valve (kv 6.3), check valve, a set of insulated connecting pipes, mixing valve actuator **MP 10-230 / 140** with adapter **A065** (230 VAC, 3-point., 140 sec. / 90 degree.) and a pump **Wilo** or **Grundfos**.

Type	Cod.
Pump group SMT 83 MIX-BOX 20 with pump Wilo Yonos Para RS 15/6 RKA 130	604082
Pump group SMT 83 MIX-BOX 20 with pump GRUNDFOS UPM3 AUTO L 15 - 70	604085



Pump group SMTc 83 MIX-BOX 20

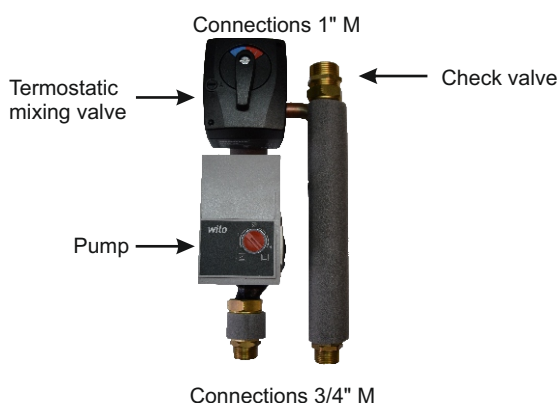

Pump group **SMTc 83 MIX-BOX 20** is equipped with a 3-way thermostatic mixing valve (DN 20, the range 20-43 °C, kv 1,6), check valve, a set of insulated connecting pipes and the pump **Wilo** or **Grundfos**.

Type	Cod.
Pump group SMTc 83 MIX-BOX 20 with pump Wilo Yonos Para RS 15/6 RKA 130	604072
Pump group SMTc 83 MIX-BOX 20 with pump GRUNDFOS UPM3 AUTO L 15 - 70	604075



Additional equipment for MIX-BOX system

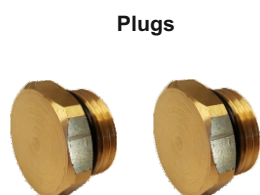

Type	Cod.
Plugs when there is no connection of the pump group. 1 set. = 2 plugs, 2 seals	604055

SYSTEM MIX - BOX DN 20 - System to power 30 kW

Perfect products for wall-hanging boilers

Hydraulic separator **CPN MIX-BOX**

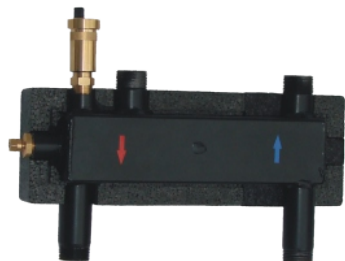

The hydraulic separator **CPN MIX-BOX** is made of steel. The factory is equipped with insulation, immersion sleeve for temperature sensor, the automatic air vent $\frac{3}{8}$ " with check valve $\frac{1}{2}$ ", two brass fittings 1" M/F.

Hydraulic separator **CPN MIX-BOX** has been produced to ensure the full adjustment of the **MIX-BOX** system.

Technical data:

Separator material:	Steel ST 37.1
Insulation separator:	EPP black 40 g / l
Max. temperature:	110 ° C
Max. flow:	1.7 m ³ / h
Max. working pressure:	6 bar

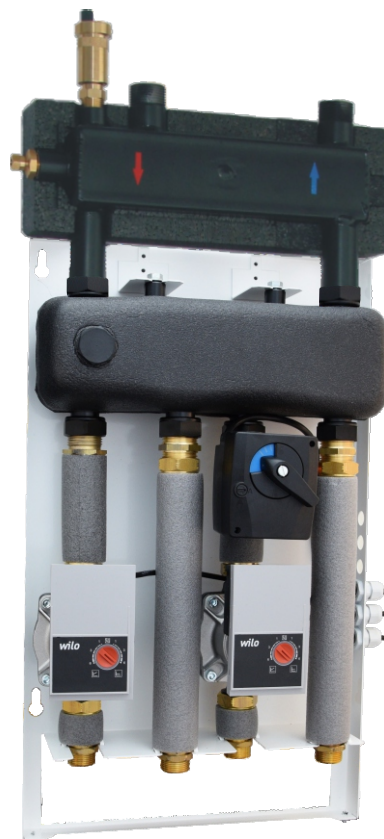

Type	Cod.
Hydraulic separator CPN MIX-BOX 2 with insulation (for system 2 circuits MIX-BOX)	604015
Hydraulic separator CPN MIX-BOX 3 with insulation (for system 3 circuits MIX-BOX)	604016

WALL-MOUNTED CABINET P3



+

+



ZONE MANIFOLD CX 3F

Do you need a set for 3 circuits?
Customize the **MIX-BOX** set to your needs.

SA 83 MIX-BOX 20



or

SMT 83 MIX-BOX 20



or

SMTC 83 MIX-BOX 20



System DN 25, DN32

All pump units in the same insulation

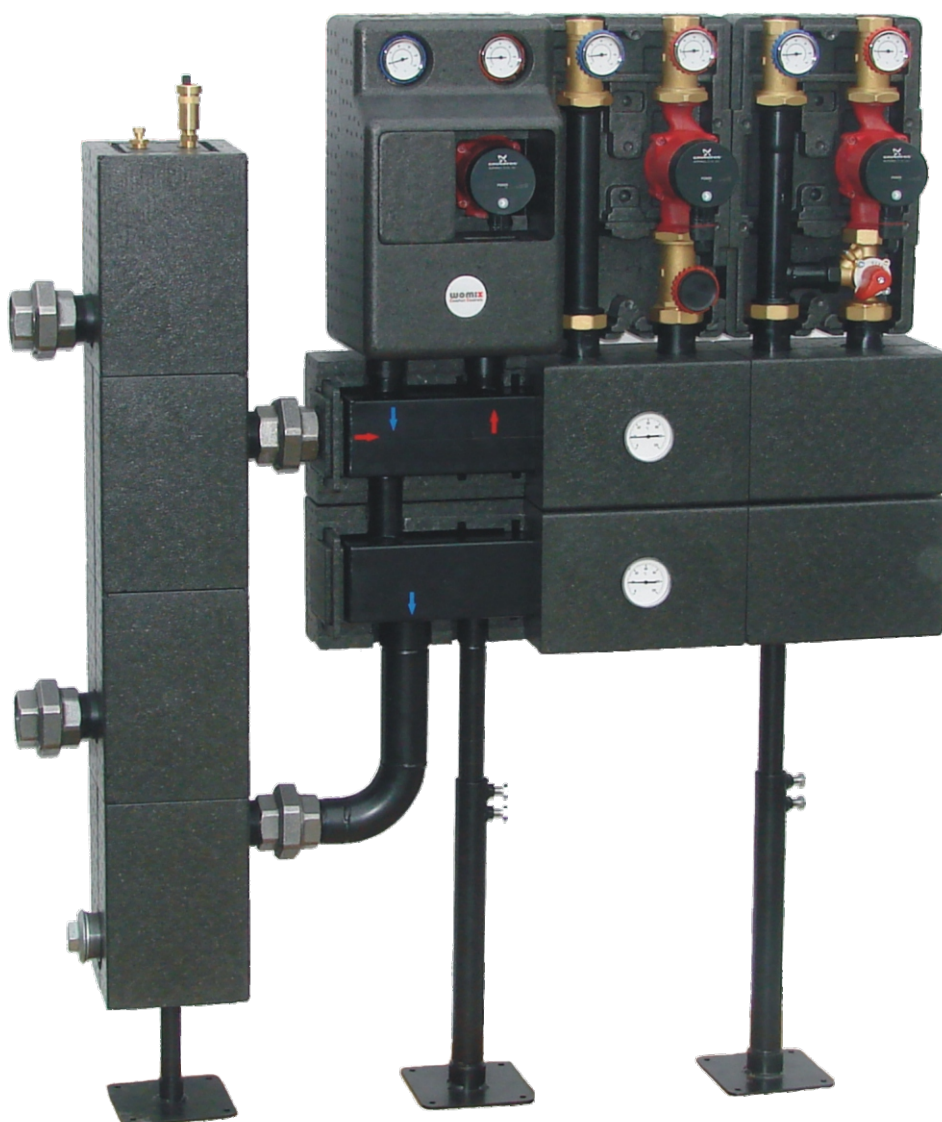

The insulation fits the pump groups of DN 25 and DN 32. With open space at the site of pumps installation we can change the settings of electronic pumps, observe the state of its work and most importantly, protect the electronics of the pump from high temperature.

Pump group DN 25, 32 common characteristics

Insulation pump group DN 25, 32 - dimensions

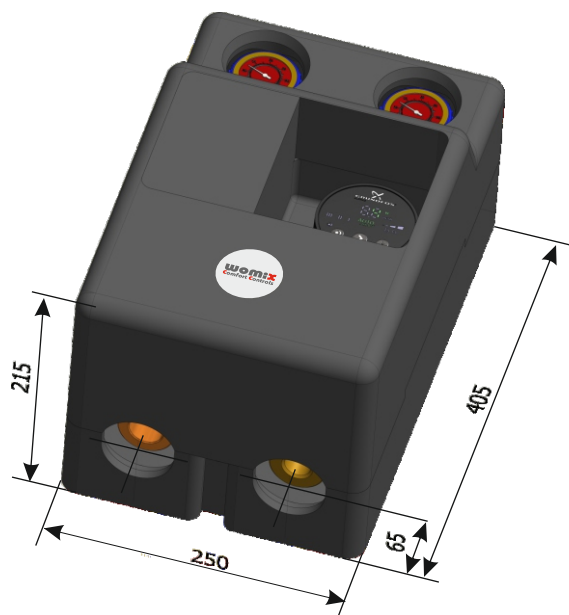

The insulation fits the pump groups of DN 25 and DN 32. With open space at the site of pumps installation, we can change the settings of electronic pumps, observe the state of its work and most importantly, protect the electronics of the pump from high temperature.

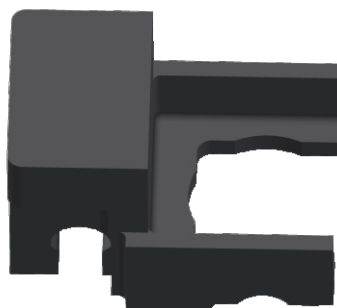
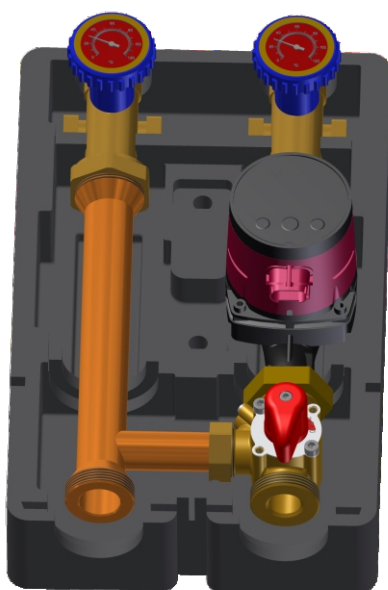

Cutting insulation - electric plug

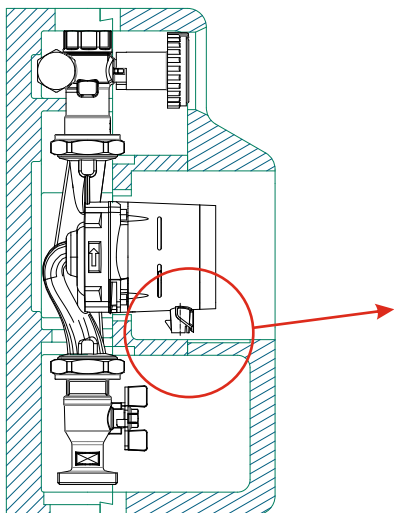

There are many different pump models on the market. There are made of different manufacturers and therefore insulation is sealed at the mounting location of power plug from the pump. Pumps are of different width as well as being various types of plug (straight, angled). Therefore, in the installation site plug, cut a hole in the insulation for example with knife.

This concept gives us the versatility of insulation, so that we have the ability to cutouts the insulation only in the place where it is necessary.

Wall mounting

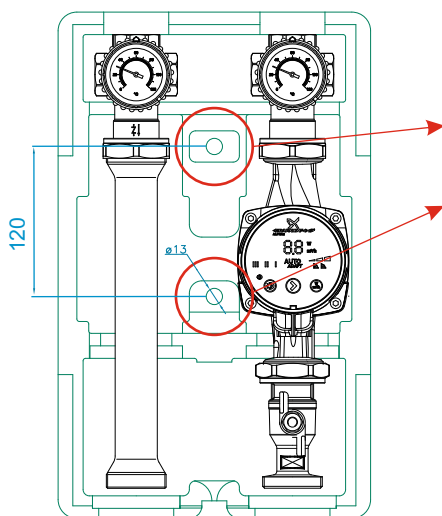

If the pump group is mounted independently, without the zone manifold, we have the ability to mount it on the wall. In insulation at designated locations in the picture are depressions. To mount it on the wall, you deepen the holes in the insulation with bit fi 13 mm or less and using expansion plugs and insulation pads screwed to the wall.

Replacement of the thermometer

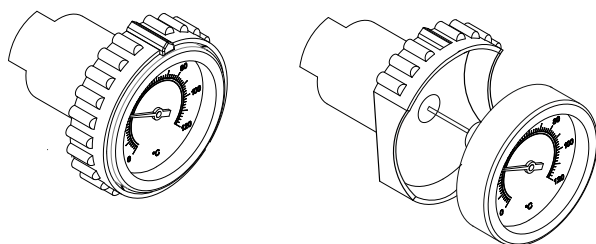

Ball valves mounted on flow and return of the pump group are equipped with thermometers. The thermometer can be changed according to the attached drawing. In the plastic handle is incision to lever and pull out thermometer.

Check valve

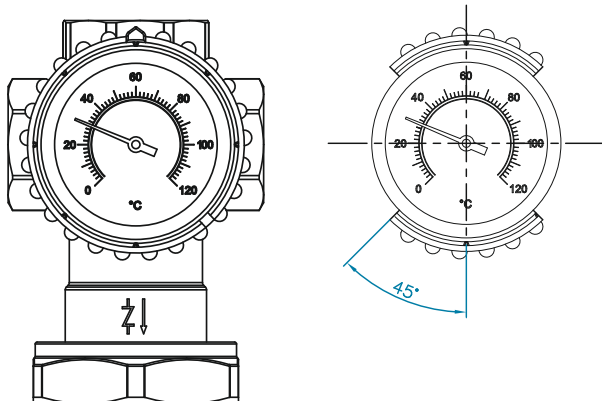

The ball valve installed on the return of the pump group is additionally equipped with a check valve.

To disable the function, turn the handle 45 degrees according to the attached drawing. (only in units DN 25)

Mounting balancing valve T25 - only for units DN 25 - ON REQUEST

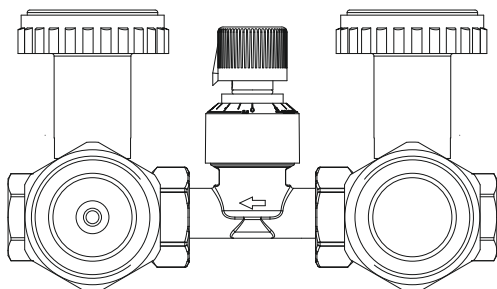

The balancing valve **T25**, assemble between ball valves with thermometers. To this end, we have to unscrew the caps in ball valves and in their place to mount the valve **T 25**. The valve is mounted on the flat seal.

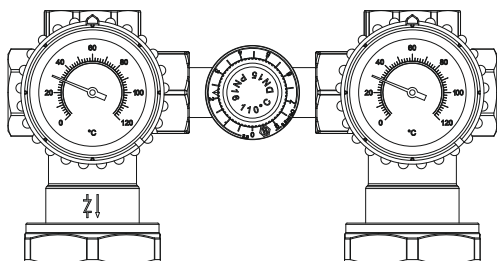

SYSTEM DN 25, DN 32

Mixing valve MIX MT 25, 32 for units SMT DN 25, 32

Dimensions

3-way mixing valve **MIX MT 25, 32** for straight-through flow, applies to small and medium-sized central heating system. It can be adjusted manually or automatically by the actuator **MP 10**.

MIX MT 25

Flat flange for a nut 1 1/2 "

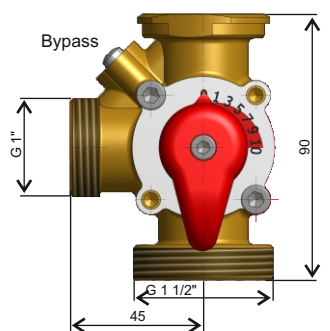

MIX MT 32

Flat flange for a nut 2 "

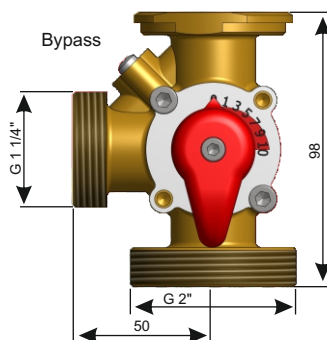

Technical data:

Dimensions: from 3/4 " to 2"
 Seal: two O-rings EPDM
 Body: brass CW617N
 Rotor and cap: brass CW617N
 Angle of rotation: 90°
 Max pressure: 10 bar
 Max temp.: 110° C
 Handle: red plastic
 Scale: aluminum

Actuator: **MP 10** (see page no. 39)

Type	Cod.
Mixing valve MIX MT 25 - DN 25	001021
Mixing valve MIX MT 32 - DN 32	001022

Possible way of work of mixing valve MIX MT

mixing valve closed

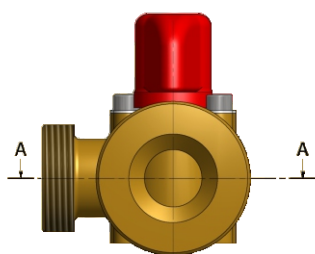

mixing valve partially open,
mixing proportional

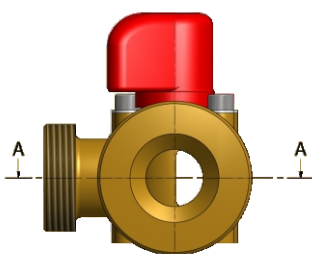

mixing valve open

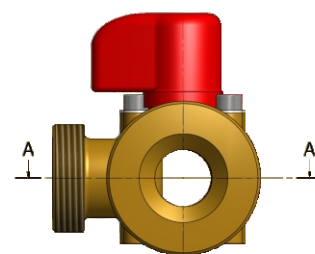

Bypass
closed

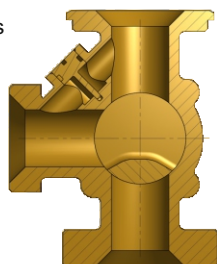

Bypass
closed

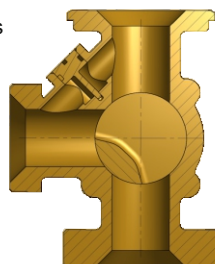

Bypass
closed

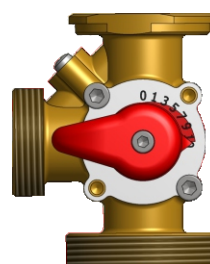
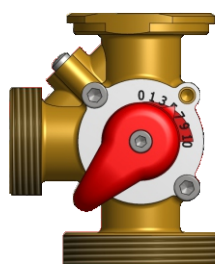
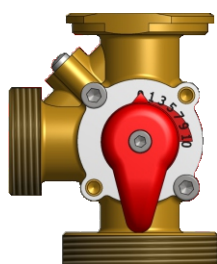
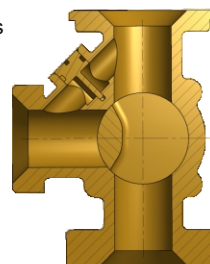

Setting bypass

Bypass in mixing valve MIX MT makes special flow between supply and return irrespective of work of valve heart.

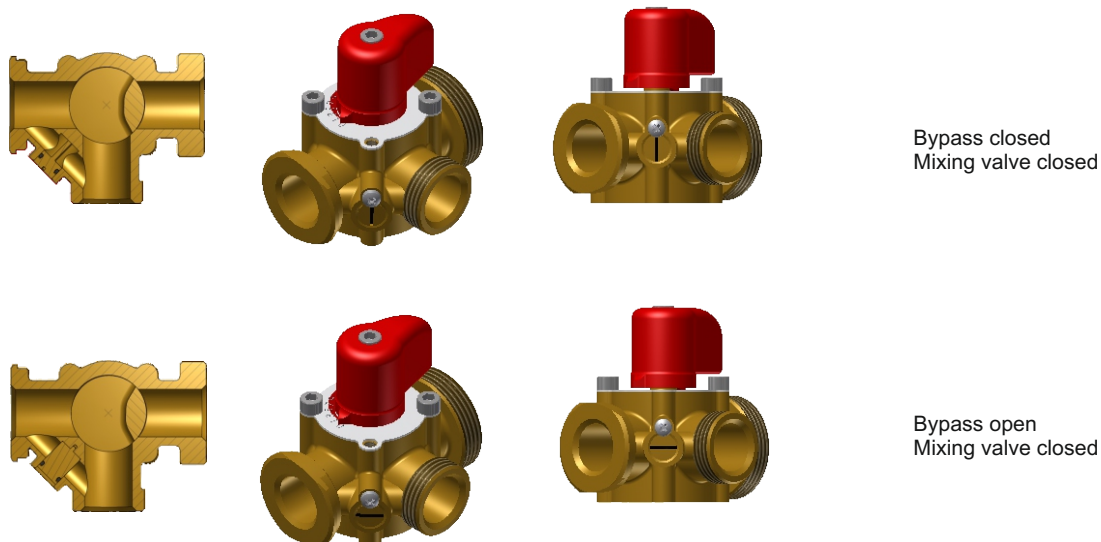

The construction of mixing valve MIX MT - change the supply side from right to left.

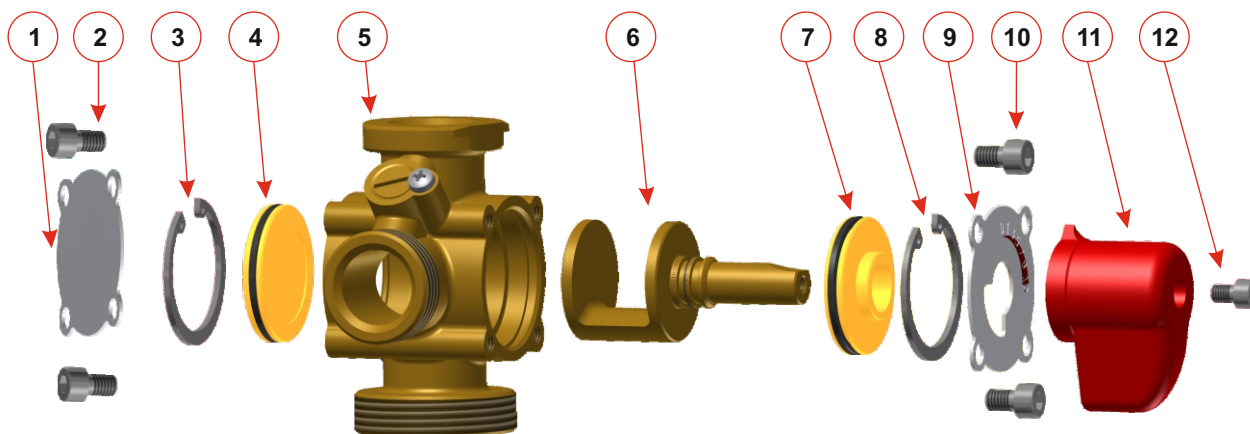

To change sides supply from right to left in the mixing valve we need:

1. Unscrew the screw M5 (12) handle (11), unscrew the screws M6 (10) scale (9), unscrew the screws M6 (2) plate (1).
2. Use pliers to remove the ring Seger (3), push the plug valve (4).
3. Use pliers to remove the ring Seger (8), push the lid sealing valve (7).
4. Remove the plug (6) and insert it into the body vice versa mixer (5).
5. Piece together the opposite valve covers (4 and 7) and lock rings Seger.
6. Tighten the scale (9) and plate (1), tighten the handle.

WARNING!

These activities should be carried out carefully to avoid damaging the seals of mixing valve.

Instruction of mounting the actuator MP on the mixing valve MIX MT

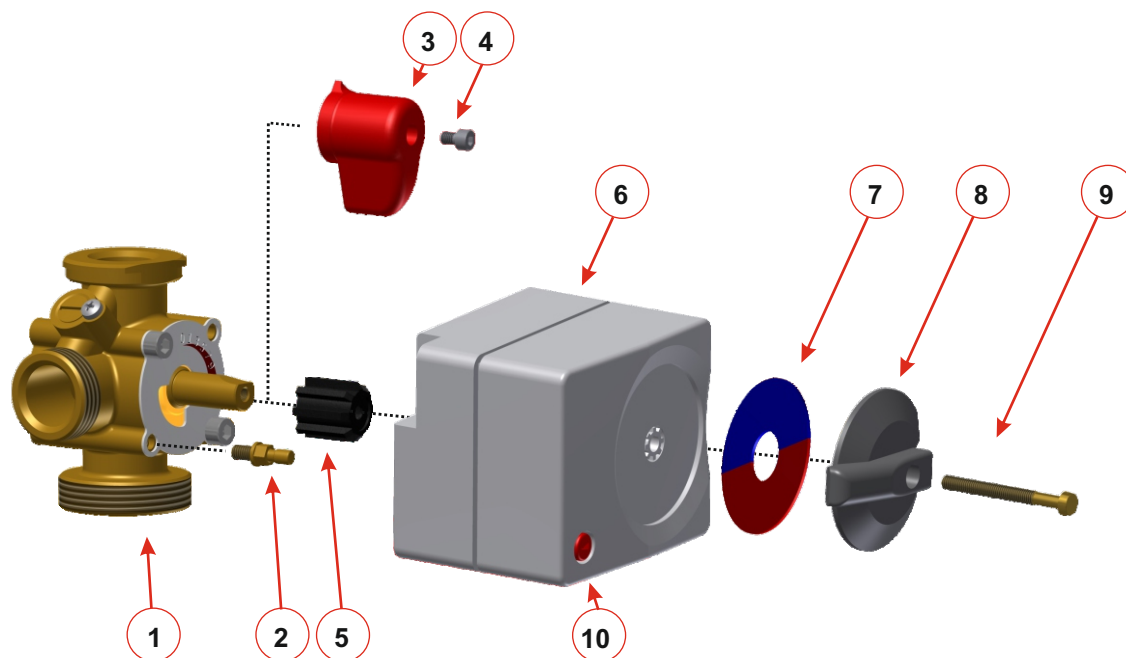

1. Set the mixing valve in the closed position (0 on the scale) or open (10 on the scale).
2. Remove the handle [3] of mixing valve [1] by removing the screw [4].
3. Screw the body of the mixing valve [1] a bolt [2] prevents rotation of the actuator around its axis.
4. Apply the valve plug adapter [5].
5. Place the actuator [6] on the adapter [5], so that the screw [2] hit the cut-out at the bottom of the actuator.
6. Apply scale [7] on actuator [6]. The scale determines the correct position way mounting the valve in the system. When movement to the right closes the plug scale valve should be turned 180 degrees so that the blue part was on the right side
7. Put the handle [8].
8. Tighten the screw [9].

The switch manual / automatic [10] enables us to validate the installation of the actuator.

Examples of assembling a group with mixing valve MIX MT Installation diagrams and scale settings

The factory setting

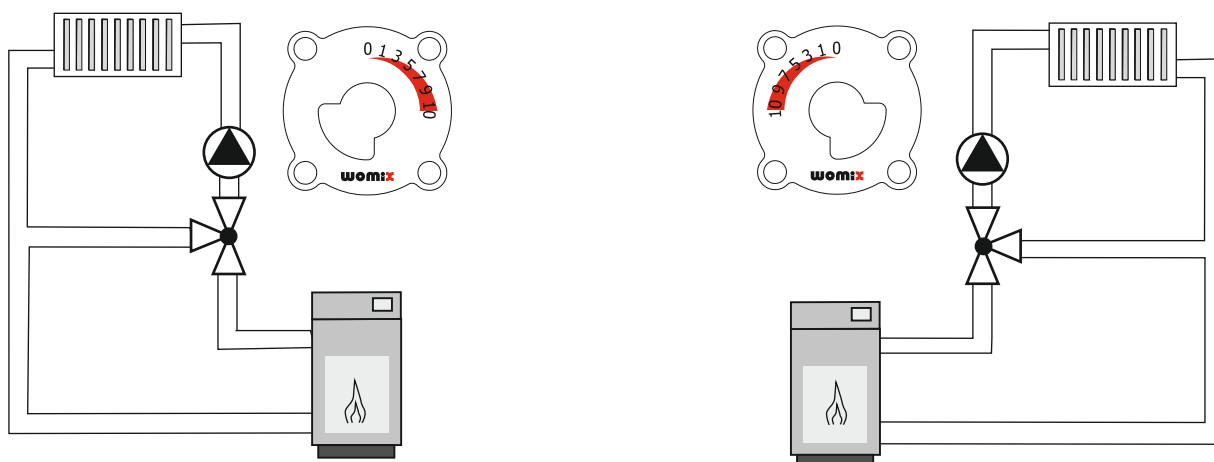

SYSTEM DN 25

Pump groups DN 25 - Complete regulation system DN 25

System of power to 45 kW

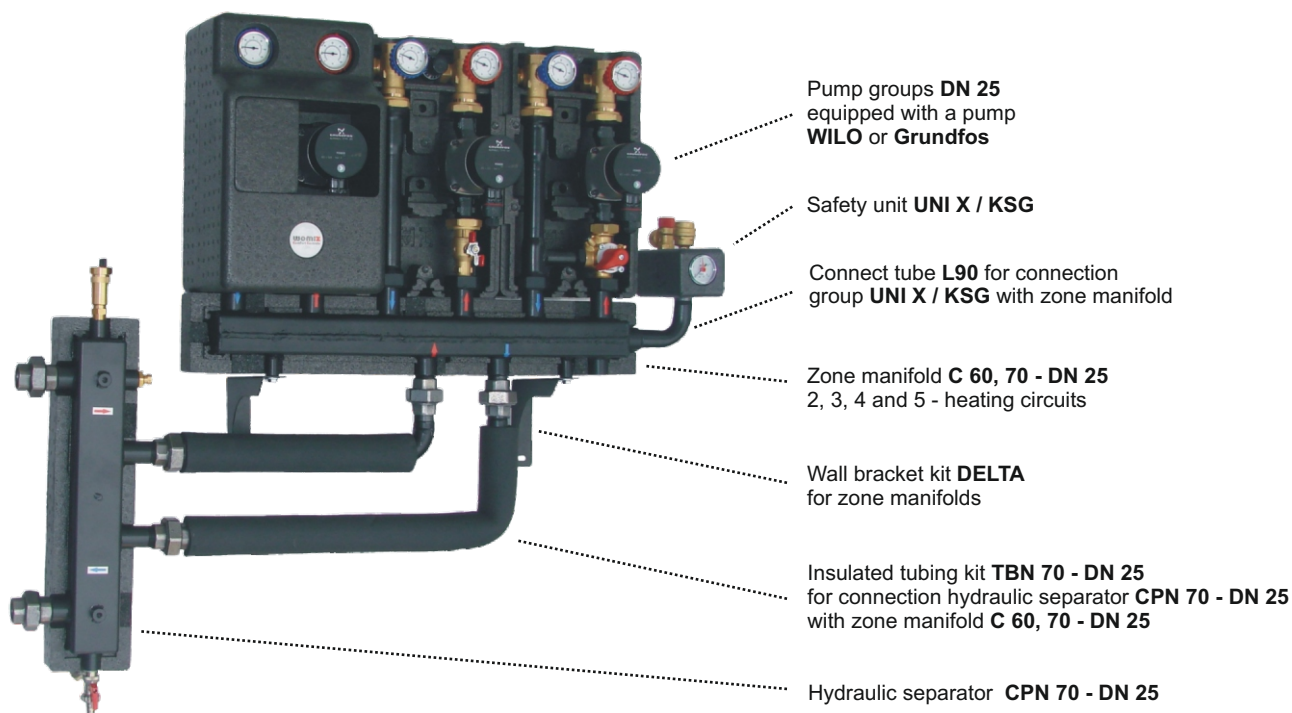

System of power to 110 kW

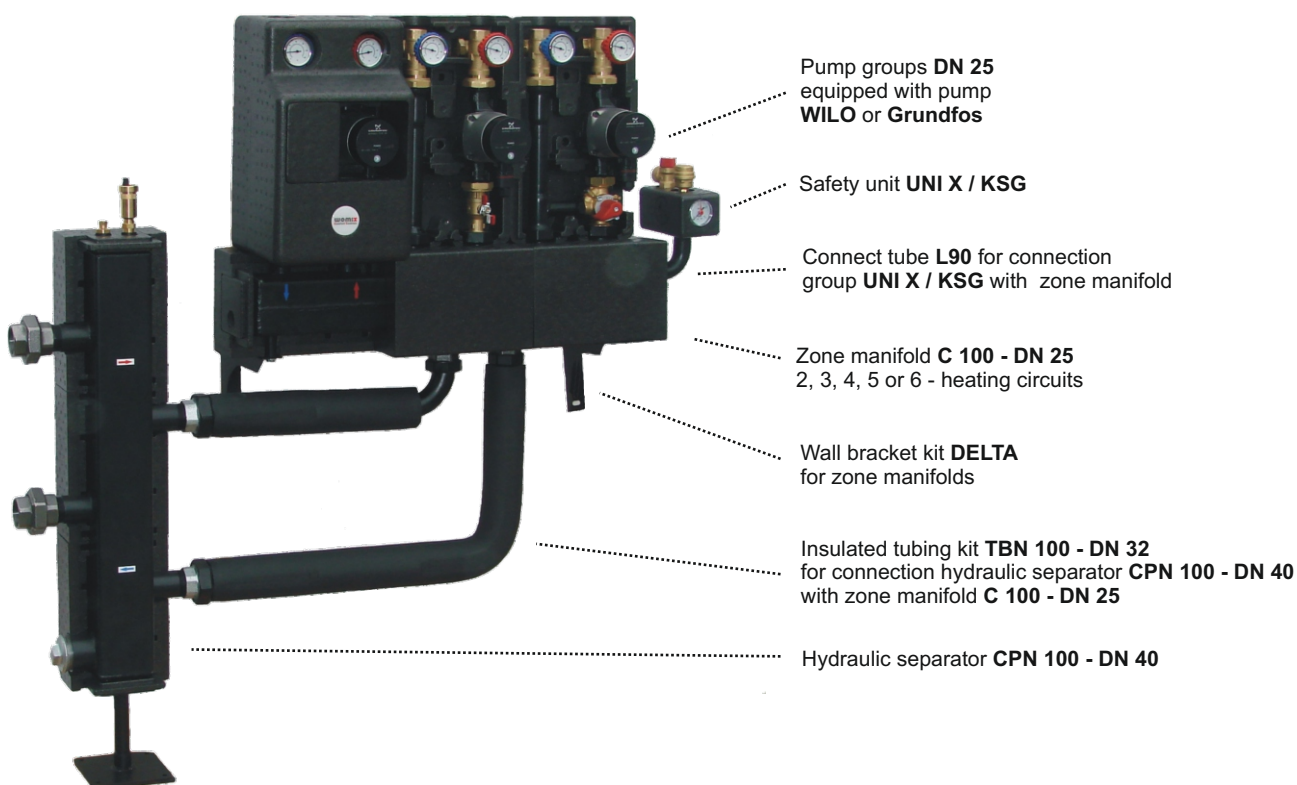

SYSTEM DN 25 - System to power 45 kW

Hydraulic separator CPN 70 - DN 25

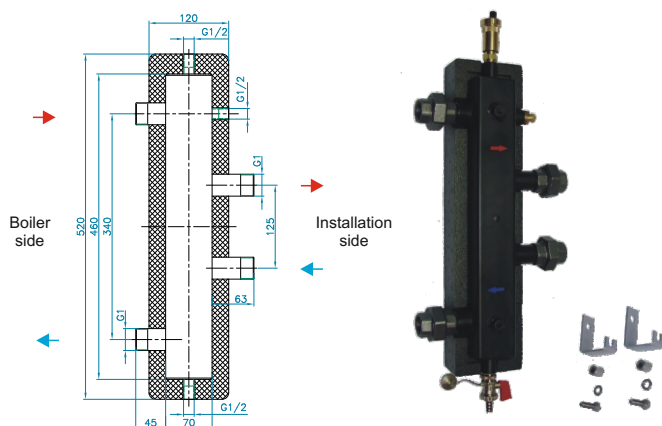

Hydraulic separator **CPN 70** is made of steel. The factory is equipped with insulation, the upper side with two connections for the temperature sensor and a vent (coupler ½" F), and the lower side of the drain connection (coupler ½" F). In the set they are automatic air vent ⅜" with check valve ½", immersion sleeve for temperature sensor ½", drain valve ½", the four cast-iron fittings 1" and wall brackets.

Technical data:

Raw material:	Steel ST 37.1
Max pressure:	8 bar
Flow rate:	2,5 m³/h
Max temp.:	110°C
Insulation material:	EPP black 40 g/l
Connections:	1"

Type	Cod.
Hydraulic separator CPN 70 - DN 25 with equipment	606002
Insulated tubing kit TBN 70/2 - DN 25 for connection C 60 2F - DN 25 with CPN 70 - DN 25	606005
Insulated tubing kit TBN 70/3 - DN 25 for connection C 60 3F - DN 25 with CPN 70 - DN 25	606006
Insulated tubing kit TBN 70/4 - DN 25 for connection C 60 4F - DN 25 with CPN 70 - DN 25	606007

Central heating zone manifold C 60 - DN 25

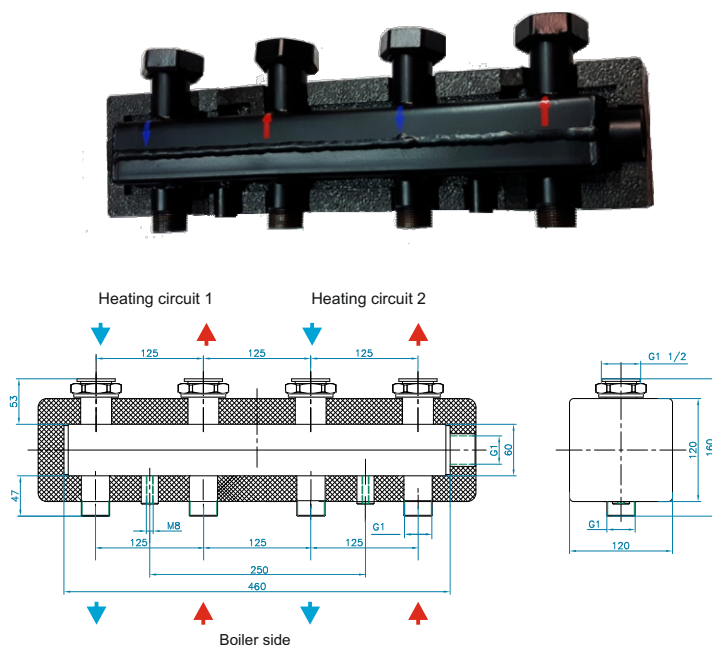

Two-chamber steel manifold **C 60 DN 25** - 2, 3 or 4 heating circuits was created to simplify installation of pump groups. The factory manifold is equipped with EPP insulation. In addition, the manifold has an output DN 20 on the return side for connecting pressure vessel and the output DN 25 on the power supply for connecting the safety group. On request, the manifold can be equipped with a set of mounting brackets on the wall **DELTA** (see bushings M8).

Technical data:

Raw material:	Steel ST 37.1
Max pressure:	8 bar
Max temp.:	110°C
Max. power:	45 kW (ΔT 20°C)
Axle spacing:	
Installation side:	125 mm
Boiler side:	125 mm
Connections:	
Installation side:	Nut 1 ½" F
Boiler side:	1" M
Insulation material:	EPP black 40 g/l

Type	Cod.
Central heating zone manifold C 60 2F - DN 25 with insulation	616011
Central heating zone manifold C 60 3F - DN 25 with insulation	616012
Central heating zone manifold C 60 4F - DN 25 with insulation	616013
Wall bracket kit DELTA for zone manifolds	606015
Check valve for pump group with mixing valve for manifold C 60	606031

HYDRAULIC SEPARATOR

Hydraulic separators CPN



Technical data:

Material:	steel ST 37.1
Max pressure:	8 bar
Max temp.:	110°C
Insulation:	EPP black 40 g/l

Type	Flow [m ³ /h]	Volume [l]	Cod.
Hydraulic separator CPN 60 - DN 20 with insulation	1,70	0,7	605002
Hydraulic separator CPN 70 - DN 25 with insulation	2,50	1,9	606002
Hydraulic separator CPN 100 - DN 32 with insulation	4,50	4,0	607001
Hydraulic separator CPN 100 - DN 40 with insulation	6,50	4,8	607002
Hydraulic separator CPN 120 - DN 50 with insulation	9,50	11,0	609001
Hydraulic separator CPN 120 - DN 65 with insulation	18,00	11,0	609002

Hydraulic separator XP



Hydraulic separator **XP** is a compensation chamber which renders connected independent hydraulic circuits. It is usually installed when the primary circuit pump interacts with one or more pumps of the secondary circuit in the same system. Therefore, it avoids problems relating to flow rate variations and circuit prevalence. It is made in square section steel, painted black. The factory is equipped with EPP insulation and wall brackets.

Technical data:

Material:	steel ST 37.1
Connections:	1" F for XP 60 - DN 25 1 1/4" F for XP 60 - DN 32 1 1/4" F for XP 80 - DN 32
Max pressure:	6 bar
Max flow:	1,8 m ³ /h for XP 60 - DN 25 2,5 m ³ /h for XP 60 - DN 32 3,0 m ³ /h for XP 80 - DN 32
Max temp.:	110°C
Insulation:	EPP black 40 g/l

Type	Flow [m ³ /h]	Volume [l]	Cod.
Hydraulic separator XP 60 - DN 25 with insulation	1,80	0,80	611021
Hydraulic separator XP 60 - DN 32 with insulation	2,50	1,25	611022
Hydraulic separator XP 80 - DN 32 with insulation	3,00	2,00	611003

SYSTEM DN 25 - System to power 110 kW

Central heating zone manifold C 100 - DN 25

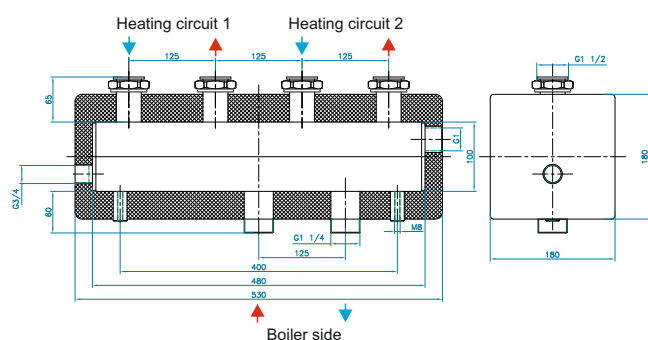

Two-chamber steel manifold **C 100 DN 25** - 2, 3, 4, 5 or 6 heating circuits was created to simplify installation of pump groups. The factory manifold is equipped with EPP insulation. In addition, the manifold has an output DN 20 on the return side for connecting pressure vessel and the output DN 25 on the power supply for connecting the safety group. On request, the manifold can be equipped with a set of mounting brackets on the wall **DELTA** (see bushings M8).

Warning! The exception is the manifold C 100 6F. The above-mentioned manifold can be equipped with a set of mounting brackets on the floor (see the socket G1 ").

Technical data:

Raw material:	Steel ST 37.1
Max pressure:	8 bar
Max temp.:	110°C
Max. power:	110 kW (ΔT 20°C)
Axle spacing:	
Installation side:	125 mm
Boiler side:	125 mm
Connections:	
Installation side:	Nut 1 1/2 " F
Boiler side:	1 1/4 " M
Insulation material:	EPP black 40 g/l

Type	Cod.
Central heating zone manifold C 100 2F - DN 25 with insulation	626011
Central heating zone manifold C 100 3F - DN 25 with insulation	626012
Central heating zone manifold C 100 4F - DN 25 with insulation	626013
Central heating zone manifold C 100 5F - DN 25 with insulation	626014
Central heating zone manifold C 100 6F - DN 25 with insulation	626015
Wall bracket kit DELTA for zone manifolds	606015
Brackets for mounting manifold on the floor (1 set = 2 pcs)	607040
Check valve for pump group with mixing valve	606031

Instructions of mounting the check valve in manifold C 60, C 100 DN 25 and C 70 DN 25

Check valve is mounting in manifold on return side of groups **SMT** or **SMTc**.

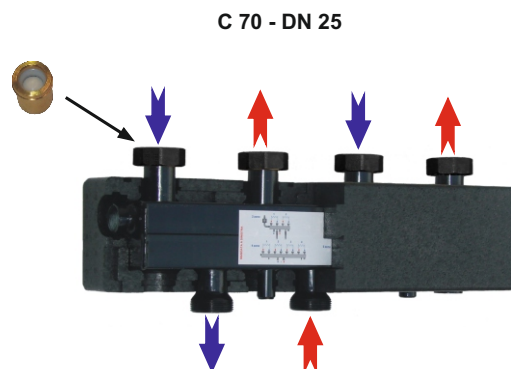
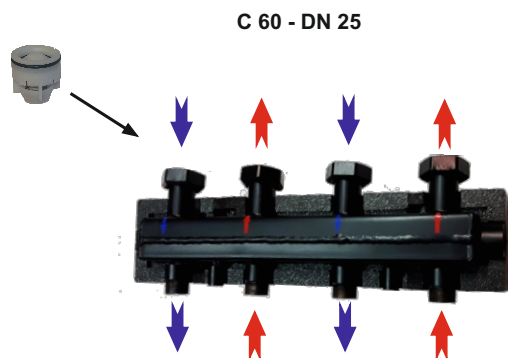

SYSTEM DN 25 - Pump group DN 25

Pump group SA 125 - DN 25 - without mixing valve



Compact pump group **SA 125 - DN 25** is equipped with three brass ball valves including two with thermometers on supply and return (with built-in check valve) steel connector and insulation. On request, the group can be equipped with a pump **Grundfos** or **Wilo**.

WARNING! Group comes from the supply side to the right. Sides can be switched.

Technical data:

Max pressure:	8 bar
Max temperature:	110 °C
Insulation material:	EPP black 60g/l
Axle spacing:	125 mm
Gaskets material:	VITON/EPDM
Connections:	
Installation side:	1" F
Boiler side:	1 1/2" M
Installation length of pump:	180 mm
Connection of the pump:	1 1/2" M

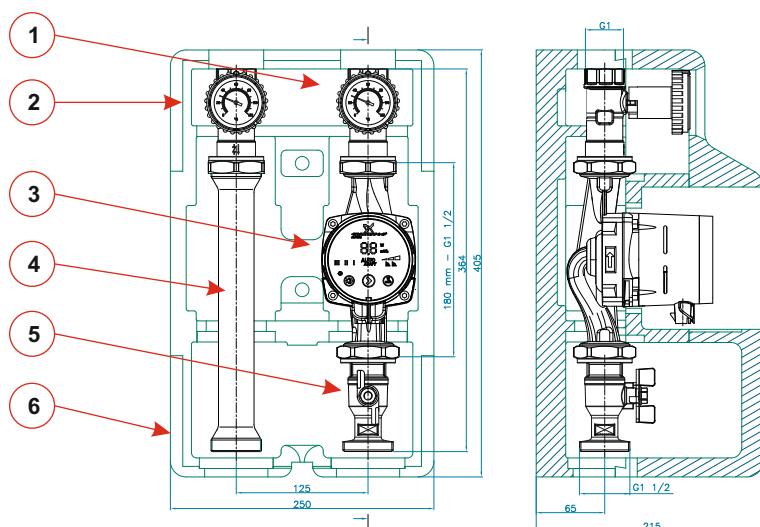

1. Ball valve with thermometer 0-120°C - supply side with the red handle.
2. Ball valve with thermometer 0-120°C and check valve - return side with the blue handle.
3. The circulating pump (Optional) **Grundfos** or **Wilo**.
4. Steel connector (spacing 272 mm).
5. Ball valve with steel handle.
6. Insulation EPP.

Type	Cod.
Pump group SA 125 - DN 25 with insulation, without pump	606051
Pump group SA 125 - DN 25 with insulation, with pump Grundfos UPM3 AUTOL 25-70	616056
Pump group SA 125 - DN 25 with insulation, with pump Grundfos Alpha 2 25 - 60	606055
Pump group SA 125 - DN 25 with insulation, with pump WILO Yonos Pico 25/1-6	616058
Pump group SA 125 - DN 25 with insulation, with pump WILO Yonos Pico 25/1-8	616059
Pump group SA 125 - DN 25 with insulation, with pump WILO Stratos Pico 25/1-6	606059
Pump group SA 125 - DN 25 with insulation, with pump Grundfos UPS 25 - 40 180 (only for countries outside the UE)	606052
Pump group SA 125 - DN 25 with insulation, with pump Grundfos UPS 25 - 55 180 (only for countries outside the UE)	606053

SYSTEM DN 25 - Pump group DN 25

Pump group SMT 125 - DN 25 - with rotary mixing valve MIX MT 25

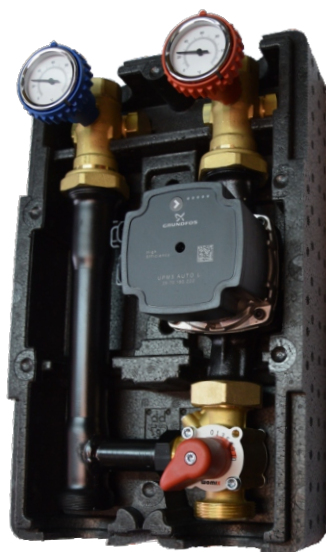

Compact mixing group **SMT 125 - DN 25** is equipped with a brass three-way mixing valve **MIX MT 25**, two brass ball valves with thermometers supply and return (with built-in check valve) steel connector and insulation. **MIX MT** mixing valve is equipped with a bypass. On requests group can be equipped with a pump **Grundfos** or **Wilo**. Additionally to ensure automatic operation of the mixing valve must be equipped with an actuator **MP 10 - 10 Nm**.

WARNING! Group comes from the supply side to the right. Sides can be switched.

Technical data:

Max pressure:	8 bar
Max temperature:	110 °C
Insulation material:	EPP black 60g/l
Axle spacing:	125 mm
Gaskets material:	VITON/EPDM
Connections:	
Installation side:	1" F
Boiler side:	1 ½" M
Installation length of pump:	180 mm
Connection of the pump:	1 ½" M

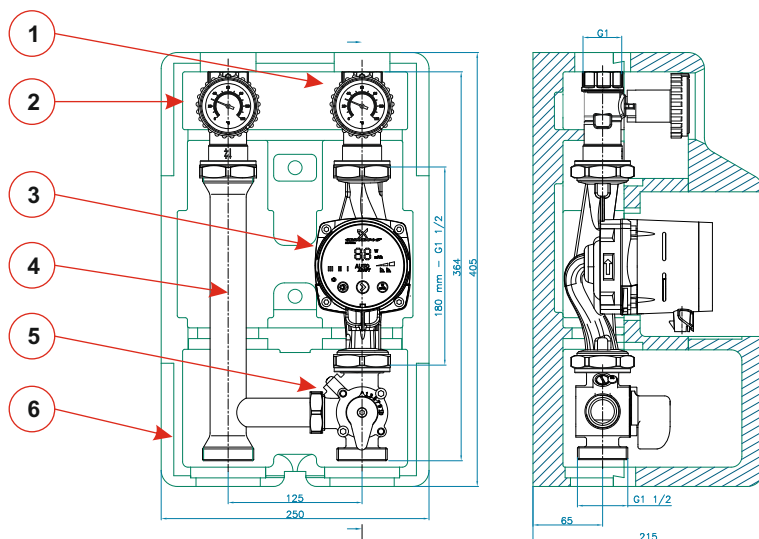

1. Ball valve with thermometer 0-120°C - supply side with the red handle.
2. Ball valve with thermometer 0-120°C and check valve - return side with the blue handle.
3. The circulating pump (Optional) **Grundfos** or **Wilo**.
4. Steel connector (spacing 272 mm).
5. Mixing valve 3-way **MIX MT 25** with bypass.
6. Insulation EPP.

Type	Cod.
Pump group SMT 125 - DN 25 with insulation, with mixing valve MT 25 , without pump	606081
Pump group SMT 125 - DN 25 with insulation, with mixing valve MT 25 , with pump Grundfos UPM3 AUTOL 25-70	616086
Pump group SMT 125 - DN 25 with insulation, with mixing valve MT 25 , with pump Grundfos Alpha 2 25 - 60	606085
Pump group SMT 125 - DN 25 with insulation, with mixing valve MT 25 , with pump WILO Yonos Pico 25/1-6	616088
Pump group SMT 125 - DN 25 with insulation, with mixing valve MT 25 , with pump WILO Yonos Pico 25/1-8	616089
Pump group SMT 125 - DN 25 with insulation, with mixing valve MT 25 , with pump WILO Stratos Pico 25/1-6	606089
Pump group SMT 125 - DN 25 with insulation, with mixing valve MT 25 , with pump Grundfos UPS 25 - 40 180	606082
Pump group SMT 125 - DN 25 with insulation, with mixing valve MT 25 , with pump Grundfos UPS 25 - 55 180	606083



SYSTEM DN 25 - Pump group DN 25

Pump group SMTC 125 - DN 25 - with thermostatic mixing valve THERMO

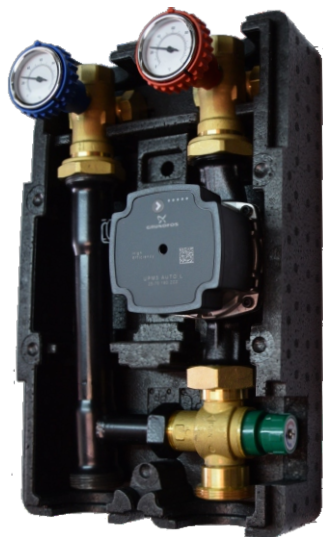

Compact thermostatic mixing group **SMTC 125 - DN 25** is equipped with a thermostatic mixing valve brass three-way **THERMO** (kv 2.7) for regulating the temperature of 20 - 47 °C or 35-60°C (depending on the model of the group), two thermometers supply and return (with built-in check valve) steel connector and insulation. On request, the group can be equipped with a pump **Grundfos** or **Wilo**.

WARNING! Group comes from the supply side to the right. Sides can be switched.

Technical data:

Max pressure: 8 bar
 Max temperature: 110 °C
 Insulation material: EPP black 60g/l
 Axle spacing: 125 mm
 kv mixing valve: 2,7
 Thermo valve adjustment: 20-47°C for group **SMTC1** or 35-60°C for group **SMTC2**
 Gaskets material: VITON/EPDM

Connections:
 Installation side: 1" F
 Boiler side: 1½ "M
 Installation length of pump: 180 mm
 Connection of the pump: 1 ½ "M

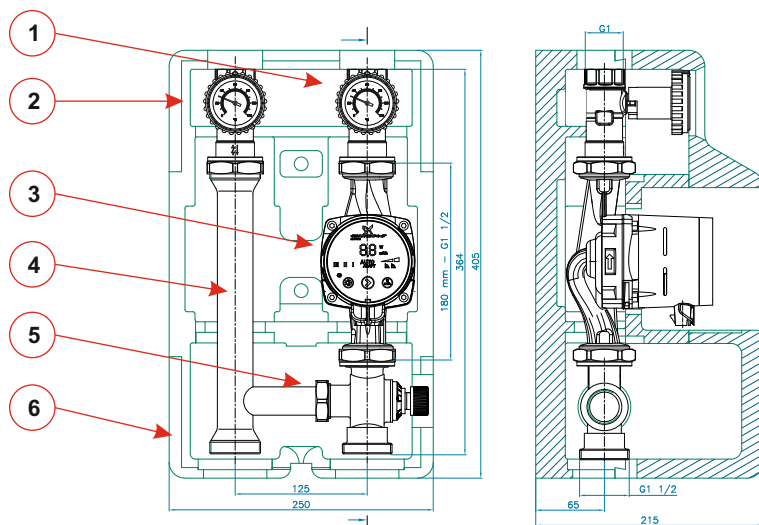

1. Ball valve with thermometer 0-120°C - supply side with the red handle.
2. Ball valve with thermometer 0-120°C and check valve - return side with the blue handle.
3. The circulating pump (Optional) **Grundfos** or **Wilo**.
4. Steel connector (spacing 272 mm).
5. Mixing valve 3-way thermostatic mixing valve **THERMO**.
6. Insulation EPP.

Type	Cod. SMTC1 20-47°C	Cod. SMTC2 35-60°C
Pump group SMTC 125 - DN 25 with insulation, without pump	606071	606091
Pump group SMTC 125 - DN 25 with insulation, with pump Grundfos Alpha UPM3 AUTOL 25-70	616076	616096
Pump group SMTC 125 - DN 25 with insulation, with pump Grundfos Alpha 2 25 - 60	606075	606095
Pump group SMTC 125 - DN 25 with insulation, with pump WILO Yonos Pico 25/1-6	616078	616098
Pump group SMTC 125 - DN 25 with insulation, with pump WILO Yonos Pico 25/1-8	616079	616099
Pump group SMTC 125 - DN 25 with insulation, with pump WILO Stratos Pico 25/1-6	606079	606099
Pump group SMTC 125 - DN 25 with insulation, with pump Grundfos UPS 25 - 40 180	606072	606092
Pump group SMTC 125 - DN 25 with insulation, with pump Grundfos UPS 25 - 55 180	606073	606093

New!

Set D



All groups equipped with pumps
Grundfos UPM3 AUTO L



Type	Cod.
Set D 1 with pump group SA 125 - DN 25 (1") and SMT 125 - DN 25 (1") with pumps Grundfos , with check valve	656001
Set D 2 with pump group SA 125 - DN 25 (1") and SMTc 125 - DN 25 (1") with pumps Grundfos , with check valve	656011
Set D 3 with 2 pump groups SMT 125 - DN 25 (1") with pumps Grundfos with 2 check valve	656021
Set D 4 with 2 pump groups SA 125 - DN 25 (1") with pumps Grundfos	656031

SYSTEM DN 25 - PREPARED SET

Set D - Perfect set for home boiler room

Set D1 - set of 2 heating circuits including one with a mixing valve and a rotary electric actuator



The system contains:

- Pump group **SA 125 - DN 25 (1")**
with pump **Grundfos UPM3 AUTO L 25 - 70**,
- Pump group **SMT 125 - DN 25 (1")**
with mixing valve 3-ways, with **Grundfos UPM3 AUTO L 25-70**,
- Zone manifold **C 60 2 F - DN 25** with insulation,
- Wall bracket kit **DELTA** for manifold **C 60 - DN 25**,
- Actuator **MP 10 - 230 / 140** with adapter **A101**,
- Check valve to manifold.

nr.art. 616056

nr.art. 616086

nr.art. 616011

nr.art. 606015

nr.art. 401011

nr.art. 606031

Set D2 - set of 2 heating circuits including one with thermostatic mixing valve



The system contains:

- Pump group **SA 125 - DN 25 (1")**
with pump **Grundfos UPM3 AUTO L 25-70**,
- Pump group with trmstostatic mixing valve **SMTc1 125 - DN 25 (1")**,
with pump **Grundfos UPM3 AUTO L 25-70**,
- Zone manifold **C 60 2 F - DN 25** with insulation,
- Wall bracket kit **DELTA** for manifold **C 60 - DN 25**.
- Check valve to manifold.

nr.art. 616056

nr.art. 616076

nr.art. 616011

nr.art. 606015

nr.art. 606031

Set D3 - set of 2 heating circuits with a mixing valves and a rotary electric actuators

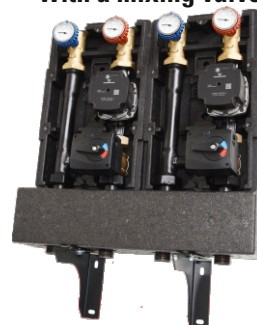

The system contains:

- 2 pump groups **SMT 125 - DN 25 (1")** with mixing valve 3-ways,
with pumps **Grundfos UPM3 AUTO L 25-70**,
- Zone manifold **C 60 2 F - DN 25** with insulation,
- Wall bracket kit **DELTA** for manifold **C 60 - DN 25**,
- 2 Actuators **MP 10 - 230 / 140** with adapter **A101**.
- 2 Check valves to manifold.

nr.art. 616086

nr.art. 616011

nr.art. 606015

nr.art. 401011

nr.art. 606031

Set D4 - set of 2 direct heating circuits without a mixing valves



The system contains:

- 2 pump groups **SA 125 - DN 25 (1")**
with pumps **Grundfos UPM3 AUTO L 25-70**,
- Zone manifold **C 60 2 F - DN 25** with insulation,
- Wall bracket kit **DELTA** for manifold **C 60 - DN 25**.

nr.art. 616056

nr.art. 616011

nr.art. 606015

New!

Set W

A set that will protect your boiler

Simplified schematic diagram of the installation - no standard installation items as well as the boiler safety scheme

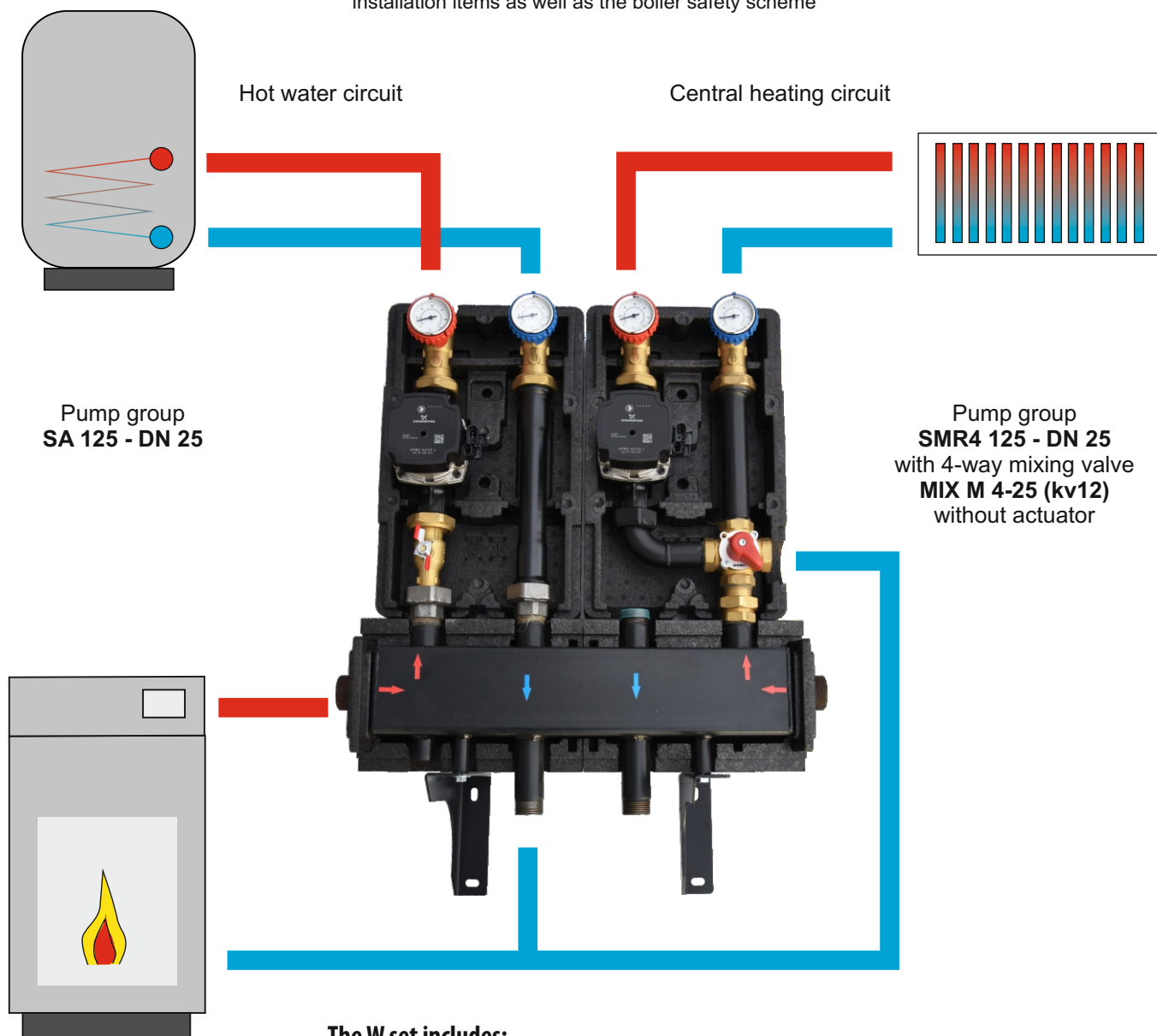

The W set includes:

- Pump group **SA 125 - DN 25 (1")**,
- Pump group with 4-way mixing valve **SMR4 125 - DN 25(1")**,
- Boiler manifold with insulation,
- Wall brackets kit **DELTA**.

Type	Cod.
Set W without pumps	656050
Set W with pumps UPM3 AUTO L 25-70	656052

SYSTEM DN 25 - System equipment

Extra equipment for groups DN 25

Balancing valve **T 25**



Wall bracket kit
DELTA for zone manifolds
C 60,70,100 DN 25



Connect tube **S**



Connect tube **L 90**



Connect tube
TBN 70 / TBN 100 / TBN 101



Group **UNI X / KSG**



Actuator **MP**



Check valve for
manifold
C60 and C100 - DN25
for mixing groups



Check valve for
manifold
C70 - DN25
for mixing groups



Brackets for mounting manifold
C 100 6F DN 25
on the floor (1set. = 2 pcs)



Type	Cod.
Balancing valve T 25	610002
Actuator MP 10	see page 39
Brackets for mounting manifold C 100 6F - DN 25 on the floor (1set. = 2 pcs)	607040
Wall bracket kit DELTA for zone manifolds C 60,70,100 DN - 25	606015
Safety group 1" UNI X / KSG with safety valve. 3 bar (1/2"x3/4"), automatic vent, manometer 0 - 4 bar, with insulation EPP.	606021
Connect tube L90 for connection group UNI X/KSG with manifold C 70 - DN 25	606025
Connect tube S for connection vessel with manifold C 60, 70 - DN - 25	606026
Check valve for manifold C 60 - DN 25 and C 100 - DN 25 .	606031
Check valve for manifold C70 - DN 25	606032

Type	Cod.
Insulated tubing kit TBN 70/2 - DN 25 for connection C 60 or 70 2F - DN 25 with CPN 70 - DN 25	606005
Insulated tubing kit TBN 70/3 - DN 25 for connection C 60 or 70 3F - DN 25 with CPN 70 - DN 25	606006
Insulated tubing kit TBN 70/4 - DN 25 for connection C 60 or 70 4F - DN 25 with CPN 70 - DN 25	606007
Insulated tubing kit TBN 70/5 - DN 25 for connection C 70 5F - DN 25 with CPN 70 - DN 25	606008

Type	Cod.
Insulated tubing kit TBN 100/2 - DN 32 for connection C 100 2F - DN 25 with CPN 100 - DN 40	607005
Insulated tubing kit TBN 100/3 - DN 32 for connection C 100 3F - DN 25 with CPN 100 - DN 40	607006
Insulated tubing kit TBN 100/4 - DN 32 for connection C 100 4F - DN 25 with CPN 100 - DN 40	607007
Insulated tubing kit TBN 100/5 - DN 32 for connection C 100 5F - DN 25 with CPN 100 - DN 40	607008
Insulated tubing kit TBN 100/6 - DN 32 for connection C 100 6F - DN 25 with CPN 100 - DN 40	607009

Type	Cod.
Insulated tubing kit TBN 101/2 - DN 32 for connection C 100 2F - DN 25 with CPN 100 - DN 40	617005
Insulated tubing kit TBN 101/3 - DN 32 for connection C 100 3F - DN 25 with CPN 100 - DN 40	617006
Insulated tubing kit TBN 101/4 - DN 32 for connection C 100 4F - DN 25 with CPN 100 - DN 40	617007
Insulated tubing kit TBN 101/5 - DN 32 for connection C 100 5F - DN 25 with CPN 100 - DN 40	617008
Insulated tubing kit TBN 101/6 - DN 32 for connection C 100 6F - DN 25 with CPN 100 - DN 40	617009

SYSTEM DN 32

Pump groups DN 32 - Complete regulation system DN 32

System of power to 120 kW

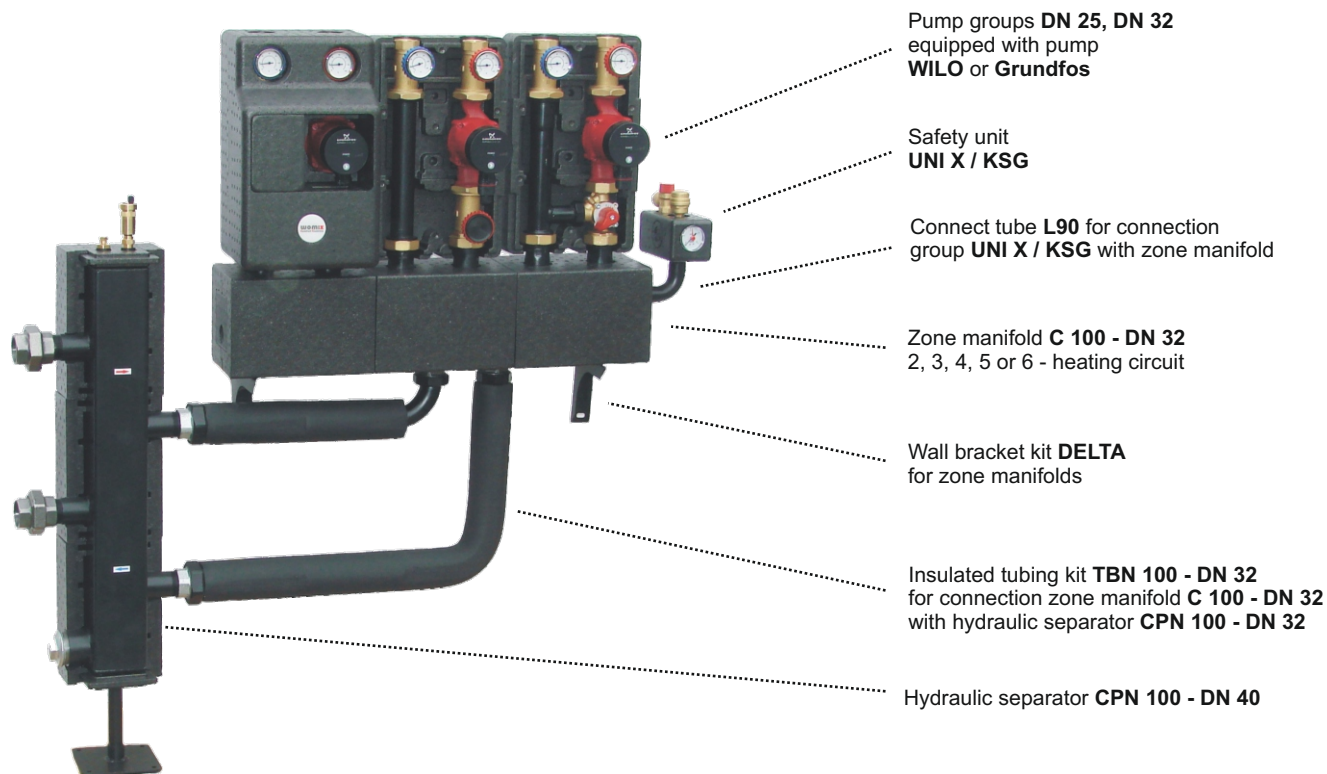

System of power to 220 kW

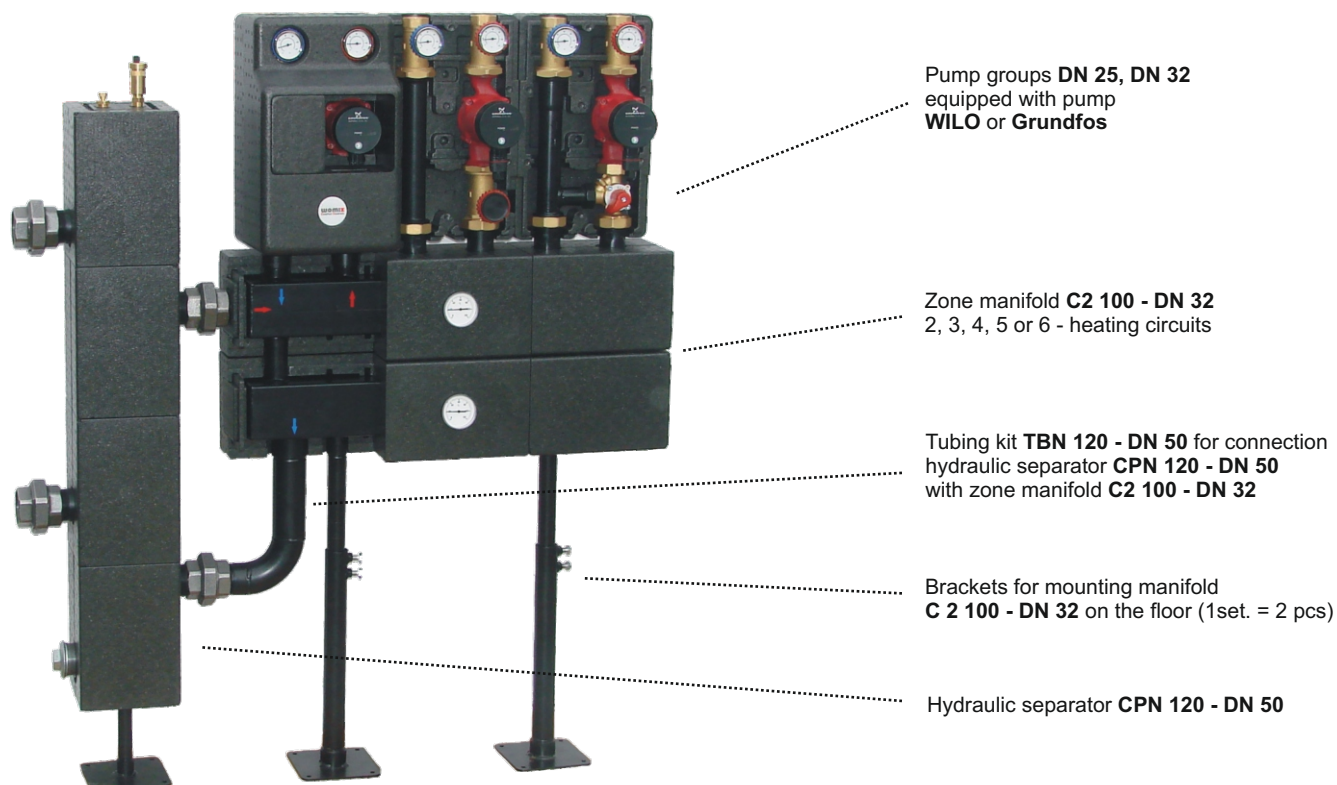

HYDRAULIC SEPARATOR

Hydraulic separator CPN 100 - DN 32 max power to 80 kW

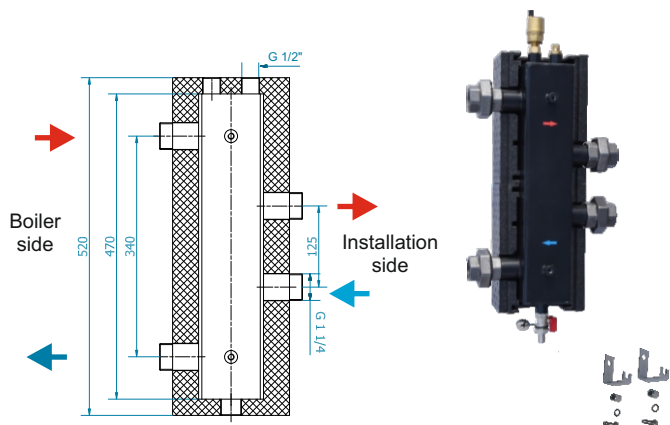

Hydraulic separator **CPN 100 DN 32** is made of steel. The factory is equipped with insulation, and the upper side with two connections for the temperature sensor and a vent (coupler 1/2" M), and the lower side of the drain connection (coupler 1/2" M). In the set they are automatic air vent 3/8" with check valve 1/2", immersion sleeve for temperature sensor 1/2", the four cast-iron fittings 1 1/2", support.

Technical data:

Raw material:	steel ST 37.1
Max pressure:	8 bar
Flow rate:	4,5 m ³ /h
Max temp.:	110°C
Insulation material:	EPP black 40 g/l
Connections:	1 1/4"

Type	Cod.
Hydraulic separator CPN 100 - DN 32 with equipment	607001
Insulated tubing kit TBN 101 / 2 for connection CPN 100 - DN 32 with C 100 2F	617005
Insulated tubing kit TBN 101 / 3 for connection CPN 100 - DN 32 with C 100 3F	617006
Insulated tubing kit TBN 101 / 4 for connection CPN 100 - DN 32 with C 100 4F	617007
Insulated tubing kit TBN 101 / 5 for connection CPN 100 - DN 32 with C 100 5F	617008
Insulated tubing kit TBN 101 / 6 for connection CPN 100 - DN 32 with C 100 6F	617009

Hydraulic separator CPN 100 - DN 40 max power to 120 kW

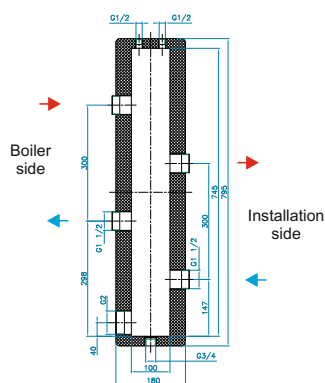

Hydraulic separator **CPN 100** is made of steel. The factory is equipped with insulation, and the upper side with two connections for the temperature sensor and a vent (coupler 1/2" M), and the lower side of the drain connection (coupler 2" F). In the set they are automatic air vent 3/8" with check valve 1/2", immersion sleeve for temperature sensor 1/2", the four cast-iron fittings 1 1/2" and mounting feet.

Technical data:

Raw material:	Steel ST 37.1
Max pressure:	8 bar
Flow rate:	6,5 m ³ /h
Max temp.:	110°C
Insulation material:	EPP black 40 g/l
Connections:	1 1/2"

Type	Cod.
Hydraulic separator CPN 100 - DN 40 with equipment	607002
Insulated tubing kit TBN 100/2 - DN 32 for connection C 100 2F - DN 25 with CPN 100 - DN 40	607005
Insulated tubing kit TBN 100/3 - DN 32 for connection C 100 3F - DN 25 with CPN 100 - DN 40	607006
Insulated tubing kit TBN 100/4 - DN 32 for connection C 100 4F - DN 25 with CPN 100 - DN 40	607007
Insulated tubing kit TBN 100/5 - DN 32 for connection C 100 5F - DN 25 with CPN 100 - DN 40	607008
Insulated tubing kit TBN 100/6 - DN 32 for connection C 100 6F - DN 25 with CPN 100 - DN 40	607009

Central heating zone manifold C 100 - DN 32

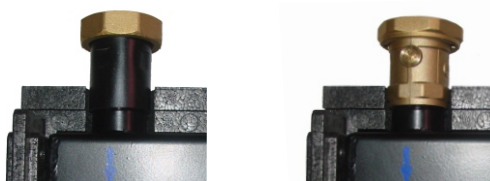
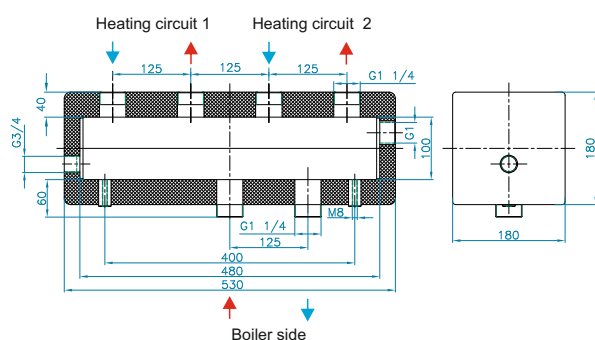

Two-chamber steel manifold **C 100 DN 32** - 2, 3, 4, 5 or 6 heating circuits was created to simplify installation of pump groups DN 32. The factory manifold is equipped with EPP insulation. In addition, the manifold has an output DN 20 on the boiler side for connecting pressure vessel and the output DN 25 on the installation side for connecting the safety group. On request, the manifold can be equipped with a set of mounting brackets on the wall **DELTA** (see bushings M8).

WARNING! The manifold can be equipped with a set of mounting brackets on the floor (see the socket G1").

WARNING! In order to connect the DN 32 group to the manifold it is necessary to buy additional connections DN 1 1/4" x 2" or connections with integrated ball valve (see below).

Technical data:

Raw material:	Steel ST 37.1
Max pressure:	8 bar
Max temp.:	110°C
Max. power:	120 kW (ΔT 20°C)
Axle spacing:	
Installation side:	125 mm
Boiler side:	125 mm
Connections:	
Installation side:	1 1/4" M
Boiler side:	1 1/4" M
Insulation:	EPP black 40 g/l

Type	Cod.
Central heating zone manifold C 100 2F - DN 32 with insulation	607011
Central heating zone manifold C 100 3F - DN 32 with insulation	607012
Central heating zone manifold C 100 4F - DN 32 with insulation	607013
Central heating zone manifold C 100 5F - DN 32 with insulation	607014
Central heating zone manifold C 100 6F - DN 32 with insulation	607015
Wall bracket kit DELTA for zone manifolds	606015
Brackets for mounting manifold on the floor (1 set = 2 pcs)	607040
Connection DN 1 1/4" x 2" with brass nut	607016
Connection DN 1 1/4" x 2" with brass nut, with check valve for groups SMT	607018
Connection DN 1 1/4" x 2" with built-in ball valve, with brass nut	607017

SYSTEM DN 32 - System to power 220 kW

Hydraulic separator CPN 120 - DN 50

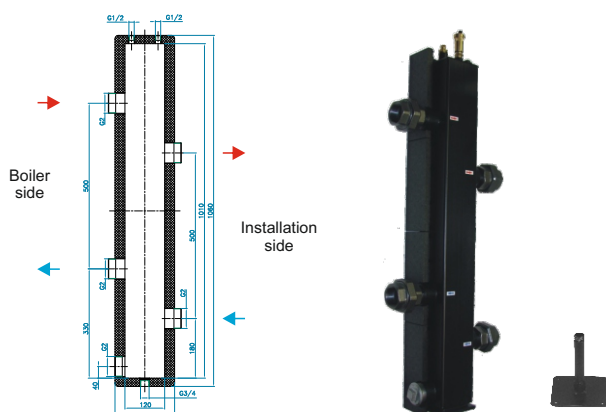

Hydraulic separator **CPN 120** is made of steel. The factory is equipped with insulation, and the upper side with two connections for the temperature sensor and a vent (coupler 1/2" M), and the lower side of the drain connection (coupler 2" M). In the set they are automatic air vent 3/8" with check valve 1/2", immersion sleeve for temperature sensor 1/2", the four cast-iron fittings 2", suport.

Technical data:

Raw material:	Steel ST 37.1
Max pressure:	8 bar
Flow rate:	9,5 m ³ /h
Max temp.	110°C
Insulation material:	EPP black 40 g/l
Connections:	2"

Type	Cod.
Hydraulic separator CPN 120 - DN 50 with equipment	609001
Connect tube TBN 120 - DN 50 for connection C2 100 - DN 32 with CPN 120 - DN 50	609005

Central heating zone manifold C2 100 - DN 32

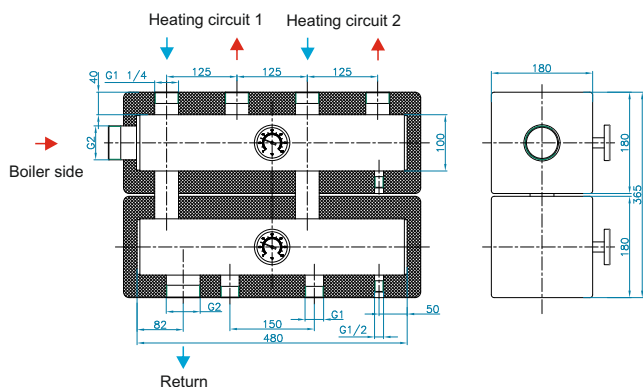
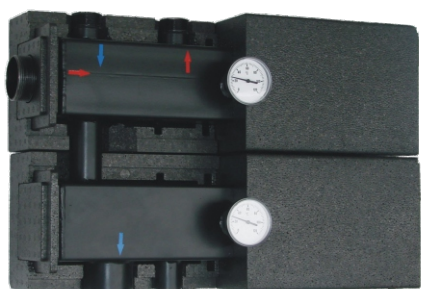

Two-chamber steel manifold **C2 100 DN 32** - 2, 3, 4, 5 or 6 heating circuits was created to simplify installation of pump groups. The factory manifold is equipped with EPP insulation. Additional manifold is equipped with two thermometers and two the socket 1/2" F drain.

WARNING! In order to connect the DN 32 group to the manifold it is necessary to buy additional connections DN 1 1/4" x 2" or connections with integrated ball valve (see page no. 30).

Technical data:

Raw material:	Steel ST 37.1
Max pressure:	6 bar
Max temp.:	110°C
Max power:	220 kW (ΔT 20°C)
Axle spacing:	
Installation side:	125 mm
Connections:	
Installation side:	1 1/4" M
Boiler side:	2"
Insulation material:	EPP black 40 g/l

Type	Cod.
Central heating zone manifold C2 100 2F - DN 32 with insulation	607041
Central heating zone manifold C2 100 3F - DN 32 with insulation	607042
Central heating zone manifold C2 100 4F - DN 32 with insulation	607043
Central heating zone manifold C2 100 5F - DN 32 with insulation	607044
Central heating zone manifold C2 100 6F - DN 32 with insulation	607045
Brackets for mounting manifold on the floor (1 set = 2 pcs)	607040
Connection DN 1 1/4" x 2" with brass nut	607016
Connection DN 1 1/4" x 2" with brass nut, with check valve for groups SMT	607018
Connection with built-in ball valve DN 1 1/4" x 2" with brass nut	607017

SYSTEM DN 32 - PUMP GROUP

Pump group SA 125 - DN 32



Compact pump group **SA 125 - DN 25** is equipped with three brass ball valves including two with thermometers supply and return (with built-in check valve) steel connector and insulation. On request, the group can be equipped with a pump **Grundfos** or **Wilo**.

WARNING! Group comes from the supply side to the right. Sides can be switched.

Technical data:

Max pressure:	8 bar
Max temperature:	110 °C
Insulation material:	EPP black 60g/l
Axle spacing:	125 mm
Gaskets material:	VITON/EPDM
Connections:	
Installation side:	1" 1/4 F
Boiler side:	2" M
Installation length of pump:	180 mm
Connection of the pump:	2" M

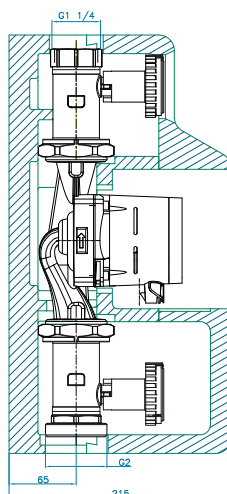
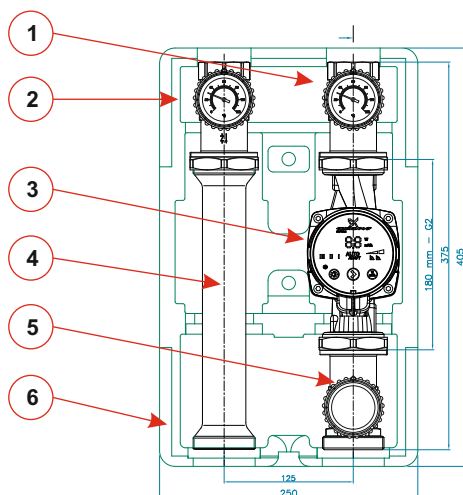

1. Ball valve with thermometer 0-120°C - supply side with the red handle.
2. Ball valve with thermometer 0-120°C and check valve - return side with the blue handle.
3. The circulating pump (Optional) **Grundfos** or **Wilo**.
4. Steel connector (spacing 280 mm).
5. Ball Valve with steel handle.
6. Insulation EPP.

Type	Cod.
Pump group SA 125 - DN 32 (1 1/4") with insulation, without pump	607051
Pump group SA 125 - DN 32 (1 1/4") with insulation, with pump Grundfos Alpha 2 32 - 60	607054
Pump group SA 125 - DN 32 (1 1/4") with insulation, with pump Grundfos Alpha 1 L 32-60	607055
Pump group SA 125 - DN 32 (1 1/4") with insulation, with pump WILO Yonos Pico 30/1-6	607056
Pump group SA 125 - DN 32 (1 1/4") with insulation, with pump WILO Yonos Pico 30/1-8	607057



SYSTEM DN 32 - PUMP GROUP

Pump group SMT 125 - DN 32



Compact mixing group **SMT 125 - DN 32** is equipped with a brass three-way mixing valve **MIX MT 32**, two brass ball valves with thermometers supply and return (with built-in check valve) steel connector and insulation. **MIX MT** mixing valve is equipped with a bypass. On requests group can be equipped with a pump **Grundfos** or **Wilo**. Additionally to ensure automatic operation of the mixing valve must be equipped with an actuator **MP 10 - 10 Nm**.

WARNING! Group comes from the supply side to the right. Sides can be switched.

Technical data:

Max pressure:	8 bar
Max temperature:	110 °C
Insulation material:	EPP black 60g/l
Axle spacing:	125 mm
Gaskets material:	VITON/EPDM
Connections:	
Installation side:	1" 1/4 F
Boiler side:	2" M
Installation length of pump:	180 mm
Connection of the pump:	2" M

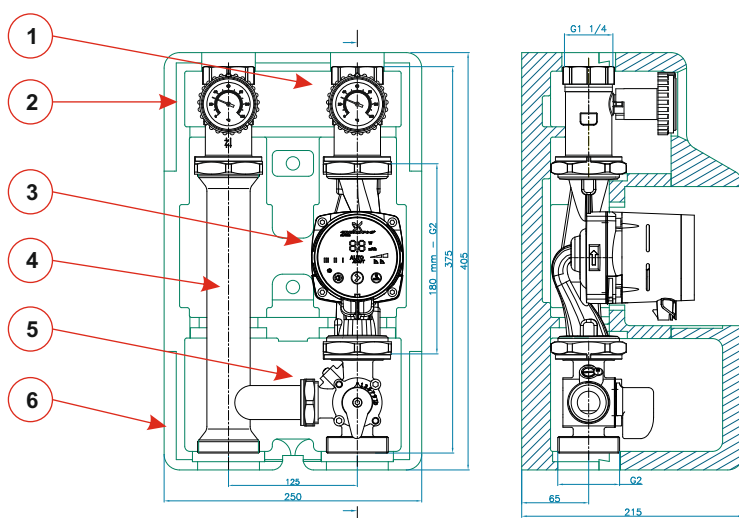

1. Ball valve with thermometer 0-120°C - supply side with the red handle.
2. Ball valve with thermometer 0-120°C, check valve - return side with the blue handle.
3. The circulating pump (Optional) **Grundfos** or **Wilo**.
4. Steel connector (spacing 280 mm).
5. Mixing valve 3-way **MIX MT 32** with bypass.
6. Insulation EPP.

Type	Cod.
Pump group SMT 125 - DN 32 (1 1/4") with insulation, with mixing valve MT 32 , without pump	607061
Pump group SMT 125 - DN 32 (1 1/4") with insulation, with mixing valve MT 32 , with Grundfos Alpha 2 32 - 60	607064
Pump group SMT 125 - DN 32 (1 1/4") with insulation, with mixing valve MT 32 , with Grundfos Alpha 1 L 32 - 60	607065
Pump group SMT 125 - DN 32 (1 1/4") with insulation, with mixing valve MT 32 , with WILO Yonos Pico 30/1-6	607066
Pump group SMT 125 - DN 32 (1 1/4") with insulation, with mixing valve MT 32 , with WILO Yonos Pico 30/1-8	607067

SYSTEM DN 32

Extra equipment for groups DN 32

Brackets for mounting manifold
C 2 100 - DN 32 and **C 100 6F 32**
on the floor (1set. = 2 pcs)



Connect tube **L 90**



Actuator **MP**



Wall bracket kit **DELTA**
for zone manifolds



Connect tube **S**



Group **UNI X / KSG**



Connection
DN 1 1/4" x 2"
with brass nut

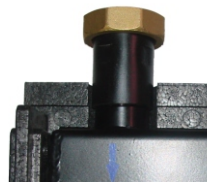

Connect tube
TB 120 - DN 50



Connection with
built-in ball valve
DN 1 1/4" x 2" with
brass nut



Connect tube
TBN 100/101 - DN 32



Reduction mounting
groups DN 25
on manifold **C 100 DN 32** or
C2 100 - DN 32



Type	Cod.
Wall bracket kit DELTA for zone manifolds C 100 - DN 32	606015
Brackets for mounting manifold C 2 100 - DN 32 and C 100 6F 32 on the floor (1set. = 2 pcs)	607040
Actuator MP 10	see page 39
Safety group 1" UNI X / KSG with safety valve. 3 bar (1/2"x3/4"), automatic vent, manometer 0 - 4 bar, with insulation EPP.	606021
Connect tube L90 for connection group UNI X/KSG with manifold C 100 - DN 32	606025
Connect tube S for connection vessel with manifold C 100	606026
Connection DN 1 1/4" x 2" with brass nut	607016
Connection DN 1 1/4" x 2" with built-in ball valve, with brass nut.	607017
Connection DN 1 1/4" x 2" with brass nut, with check valve for mixing group SMT	607018
Reduction mounting groups DN 25 on manifold C 100 DN 32 , C2 100 - DN 32 - set - 2 pcs.	607023

Type	Cod.
Insulated tubing kit TBN 100/2 - DN 32 for connection CPN 100 - 40 with C 100 2 F - DN 32	607005
Insulated tubing kit TBN 100/3 - DN 32 for connection CPN 100 - DN 40 with C 100 3 F - DN 32	607006
Insulated tubing kit TBN 100/4 - DN 32 for connection CPN 100 - DN 40 with C 100 4 F - DN 32	607007
Insulated tubing kit TBN 100/5 - DN 32 for connection CPN 100 - DN 40 with C 100 5 F - DN 32	607008
Insulated tubing kit TBN 100/6 - DN 32 for connection CPN 100 - DN 40 with C 100 6 F - DN 32	607009
Insulated tubing kit TBN 120 - DN 50 for connection CPN 120 - DN 50 with C 2 100 - DN 32	609005

Type	Cod.
Insulated tubing kit TBN 101/2 - DN 32 for connection C 100 2F - DN 25 with CPN 100 - DN 40	617005
Insulated tubing kit TBN 101/3 - DN 32 for connection C 100 3F - DN 25 with CPN 100 - DN 40	617006
Insulated tubing kit TBN 101/4 - DN 32 for connection C 100 4F - DN 25 with CPN 100 - DN 40	617007
Insulated tubing kit TBN 101/5 - DN 32 for connection C 100 5F - DN 25 with CPN 100 - DN 40	617008
Insulated tubing kit TBN 101/6 - DN 32 for connection C 100 6F - DN 25 with CPN 100 - DN 40	617009



AN EXAMPLE OF A CONNECTION DIAGRAM

An example of a connection diagram of a pump group system

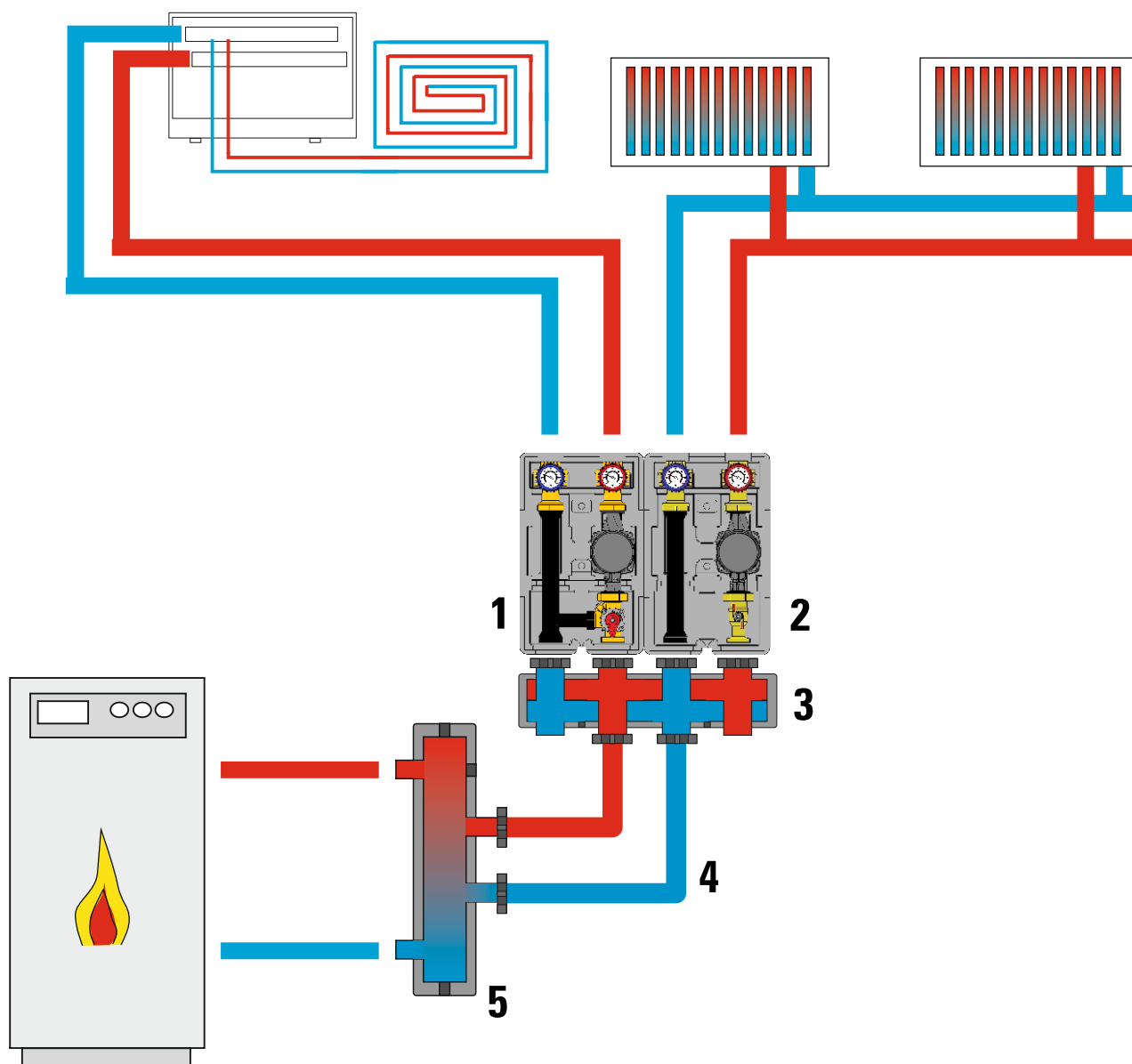

1. Pump group SMT 125 DN25 with 3-ways mixing valve
2. Pump group SA 125 DN 25
3. Zone manifold C 60 2 F DN 25
4. Insulated tubing kit TBN 70/2 DN 25
5. Hydraulic separator CPN 70 DN 25

System DN 50 - Complete regulation system

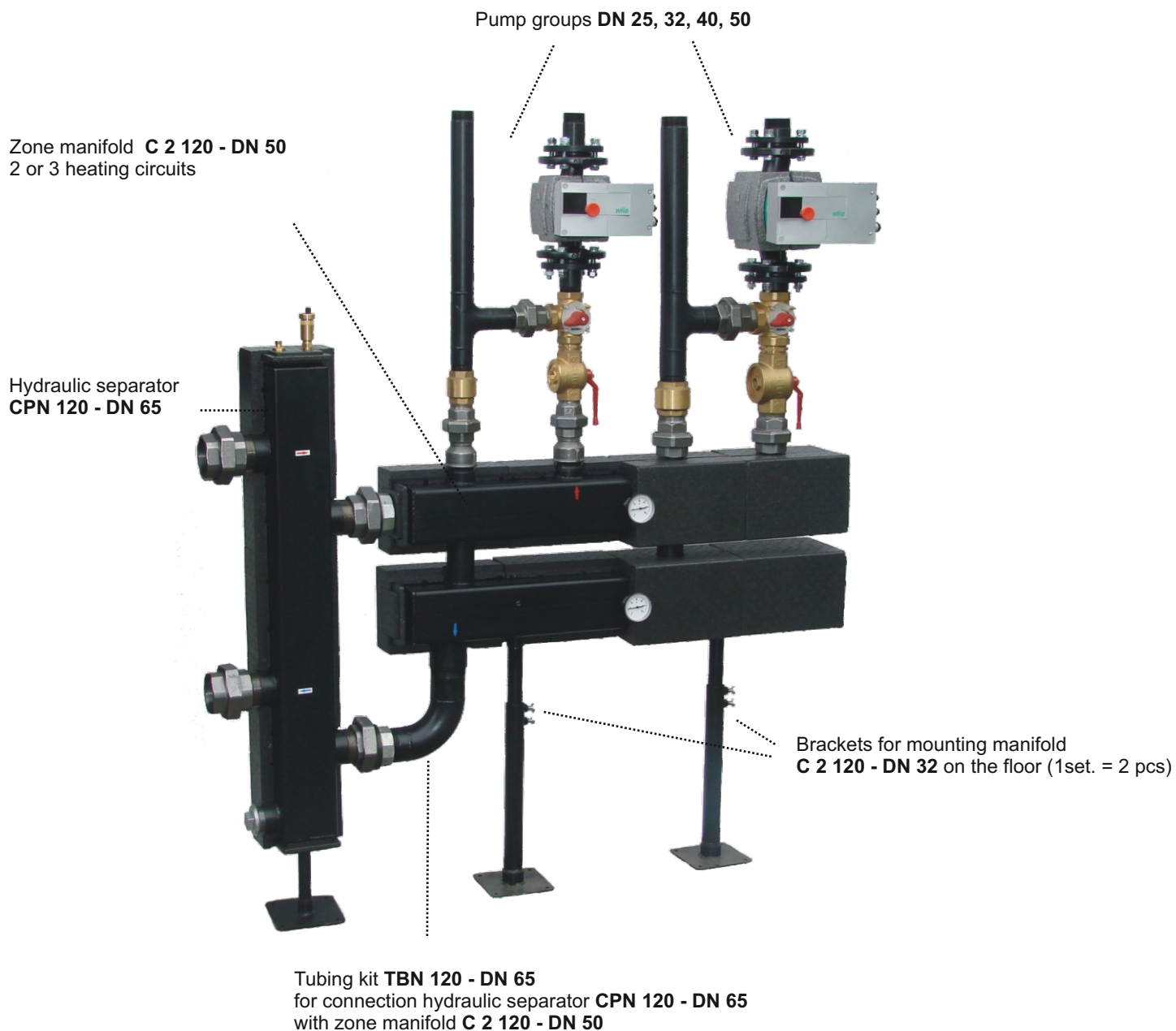

SYSTEM DN 50 - System to power 350 kW

Hydraulic separator CPN 120 - DN 65 (2 1/2")

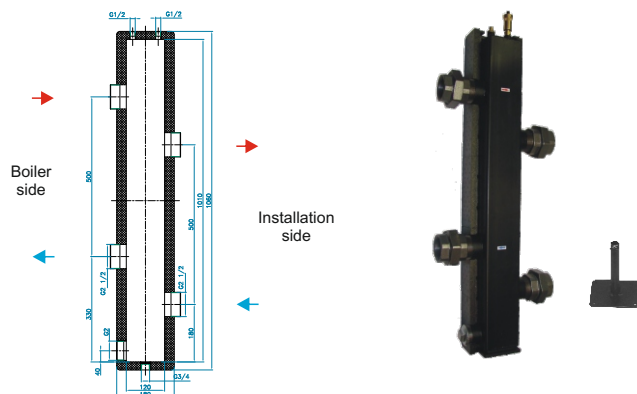

Hydraulic separator **CPN 120 – DN 65** is made of steel. The factory is equipped with insulation, the upper side have two connections for the temperature sensor and a vent (coupler 1/2" M), and the lower side of the drain connection (coupler 2" M). In the set they are automatic air vent 3/8" with check valve 1/2", immersion sleeve for temperature sensor 1/2", the four cast-iron fittings 2 1/2" and suport mounting feet.

Technical data:

Raw material:	Steel ST 37.1
Max pressure:	8 bar
Flow rate:	18 m ³ /h
Max temp:	110°C
Insulation material:	EPP black 40 g/l
Connections:	2 1/2"

Type	Cod.
Hydraulic separator CPN 120 - DN 65 with equipment	609002
Connect tube TBN 120 - DN 65 for connection CPN 120 - DN 65 with C 2 120 - DN 50	609006

Central heating zone manifold C2 120 - DN 50

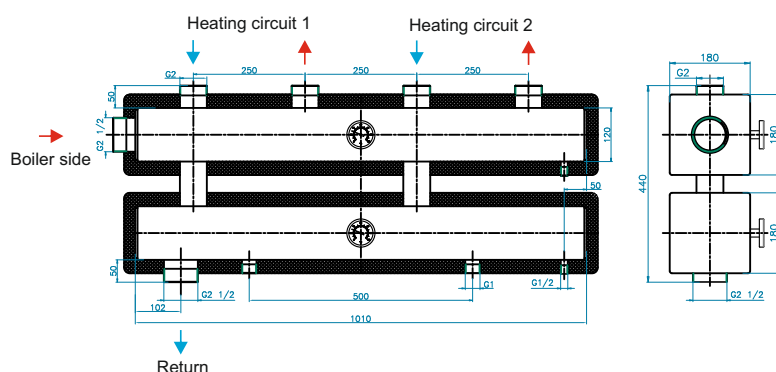
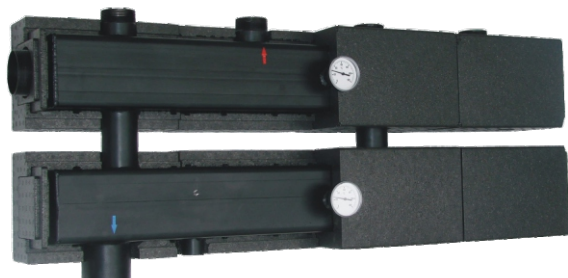

Two-chamber steel manifold **C2 120 DN 50** – 2 or 3 heating circuits was created to simplify installation of pump groups DN 25, DN 32, DN 40, DN 50 . The factory manifold is equipped with EPP insulation. Additional manifold is equipped with two thermometers and two the socket 1/2" F drain.

Technical data:

Raw material:	steel ST 37.1
Max pressure:	6 bar
Max temp.:	110°C
Max. power:	350 kW (ΔT 20°C)
Axle spacing:	
Installation side:	250 mm
Connections:	
Installation side:	2" M
Boiler side:	2 1/2"
Insulation material:	EPP black 40 g/l

Type	Cod.
Central heating zone manifold C 2 120 2 F - DN 50 with insulation	609011
Central heating zone manifold C 2 120 3 F - DN 50 with insulation	609012
Brackets for mounting manifold on the floor (1 set = 2 pcs)	607040

Actuators MP

for mixing valves



- adapted to all mixing valve Womix,
- possibility to work with other valves (various adapters),
- switch to work manual / automatic,
- control 3-points, possible 0-10V (depend of model),
- version standard 3-point or with constant temperature control,
- very simple mounting,
- 5 ,10 or 15 Nm (depend of model),
- 70 or 140 second time rotation of 90 degrees (depend of model),
- 230 VAC or 24 VAC (depend of model).



ACTUATORS

Actuators MP 10, MP 15



MP actuators consists of a synchronous motor with capacitor, two limit switches, two cams positioned on the 90 degrees, the knob, the color scale for visualizing the position of the heart of the valve, a switch for manually changing the position of the heart of the valve. The factory is equipped with a 2 meter cable 3 x 0.75 mm² and an adapter for mounting the actuator on the mixing valve **MIX M** from WOMIX - **A 101**. Using an adapter connecting actuators, **MP** can be mounted on the mixing valve manufacturing of other companies (see the numbers of adapters).

Technical data:

Nominal voltage:	230V, 60Hz or 24 V, 60Hz,
Power consumption:	3,5W, 3,5VA
Wire size:	3 x 0,75mm ² , lenght - 2m
Torque:	MP 10 - 10 Nm (for nominal voltage) MP 15 - 15 Nm (for nominal voltage)
Angle of rotation:	90°, unregulated
Running time:	70 or 140 seconds for the voltage 230 VAC 140 seconds for the voltage 24 VAC
Noise level:	max. 35 dB (A)
Position indicator:	stuck on the handle body
Protection class:	II
Degree of protection:	IP 40
Operating Temperature Range:	0 - 50°C
Weight:	350 g

switch to work: manual / automatic.

Instruction of mounting the actuator MP 10/MP 15 at the mixing valve MIX M

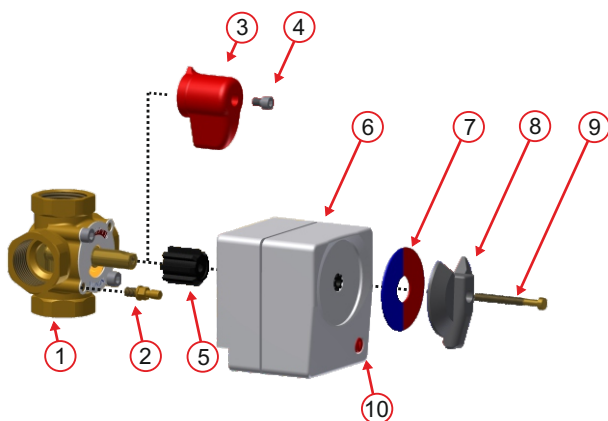

1. Set the mixing valve in the closed position (0 on the scale) or open (10 on the scale).
2. Remove the handle [3] of mixing valve [1] by removing the screw [4].
3. Screw the body of the mixing valve [1] a bolt [2] prevents rotation of the actuator around its axis.
4. Apply the valve plug adapter [5].
5. Place the actuator [6] on the adapter [5], so that the screw [2] hit the cut-out at the bottom of the actuator.
6. Apply scale [7] on actuator [6]. The scale determines the correct position way mounting the valve in the system. When movement to the right closes the plug scale valve should be turned 180 degrees so that the blue part was on the right side
7. Put the handle [8].
8. Tighten the screw [9].

The switch manual / automatic [10] enables us to validate the installation of the actuator.

Type	Torque	Open time	Voltage	Cod.
Actuator MP 10 - 230 / 70 with adapter A 101 for valve by WOMIX	10 Nm	70 s. / 90°	230 V~50Hz	401010
Actuator MP 10 - 230 / 140 with adapter A 101 for valve by WOMIX	10 Nm	140 s. / 90°	230 V~50Hz	401011
Actuator MP 10 - 24 / 140 with adapter A 101 for valve by WOMIX	10 Nm	140 s. / 90°	24 V~50Hz	401012
Actuator MP 10 - 24 / 140 (0-10V) with adapter A 101 for valve by WOMIX	10 Nm	140 s. / 90°	24 V~50Hz	401040
Actuator MP 15 - 230 / 140 with adapter A 101 for valve by WOMIX	15 Nm	140 s. / 90°	230 V~50Hz	401031

Equipment	Cod.
Adapter A 101 for MP 10 for valve by WOMIX (basic equipment)	401101
Adapter A 062 for valve by WITA Minimix and type H	401062
Adapter A 063 for valve by Meibes V7	401063
Adapter A 064 for valve by ESBE, Danfoss (old generation)	401064
Adapter A 065 for valve by ESBE VRG / VRB	401065

Actuator MP 05 CR NEW with integrated regulators



The actuators **MP 05 CR NEW** with integrated constant thermal regulator are used in central heating systems with mixing valve. The actuator maintains a constant temperature of the medium heating circuit. Through a built-in DIP switch (located under the cover of the actuator), we can choose additional functions such as:

- the direction of rotation of the actuator,
- the minimum temperature limit - a choice: +60...85°C,
- the maximum limit temperature - +25...45°C,
- protect the mixing valve from blocking.

For the device operation does not require any external controls. The work of the actuator, it means the direction of rotation of the actuator signal the LED.

Technical data:

Nominal voltage:	230 V, +/- 15V, 50 Hz
Power consumption:	3,5 VA
Connection:	230 V
Torque:	5 Nm
Angle of rotation:	90°
Running time:	140 s
Protection class:	II
Level of protection:	IP 40
Supply temp. sensor:	length 1m
Temperature range of heating:	20 - 80 °C
Temp. limit maximum	+45 °C
Temp. limit minimum	+60...85 °C

switch to work: manual / automatic.

The actuator has a display which shows the current temperature of heating circumstances and temperature required when change setting

Type	Cod.
Actuator MP 05 CR NEW with integrated regulators with adapter A 101	401051

Equipment	Cod.
Adapter A 101 for valve by WOMIX (basic equipment)	401101
Adapter A 062 for valve by WITA Minimix oraz typu H	401062
Adapter A 063 for valve by Meibes V7	401063
Adapter A 064 for valve by ESBE, Danfoss (old generation)	401064
Adapter A 065 for valve by ESBE VRG / VRB	401065

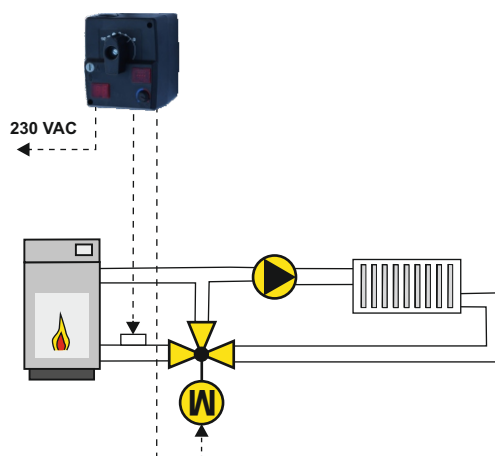
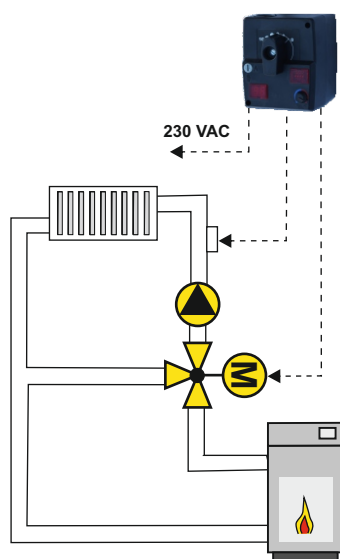

BALL VALVES

Ball valves with filters BIOFLUX



DN	15	20	25	32	40
l/sec.	1,03	1,16	2,65	3,92	4,85
m ³ /h	3,71	4,18	9,54	14,11	17,64

Destiny

Bioflux ball valve is designed for installation in heating and domestic hot water. You can not install the valve in the gas and oil installations.

Filtr

Bioflux ball valve is an exclusive purification device is incorporated in the bioflux valve which guarantees the elimination of solid residue in the plumbing. The highly innovative patent on which Bioflux valves are based enables a very simple filter cleaning and maintenance procedure, without requiring isolation of the duct. Bioflux reduces operating costs while ensuring greater resistance and durability of the plumbing system in the long term.

Bioflux valves are useful in various situations for the protection of heating systems, appliances or simply to improve water quality at home.

Environmental friendly

The materials used for the manufacture of Bioflux ball valves are suitable in 99% recyclable, further in over 50% of the materials come from recycling. Such use of material leads to considerable savings on the raw materials used as well as energy consumption.

Technical data:

Body:	Brass
Seal:	EPDM
Seal ball:	PTFE
Max pressure of work:	10 bar
Range temperature of work:	5 - 120°C
Filter material:	AISI 304
Handle:	aluminium

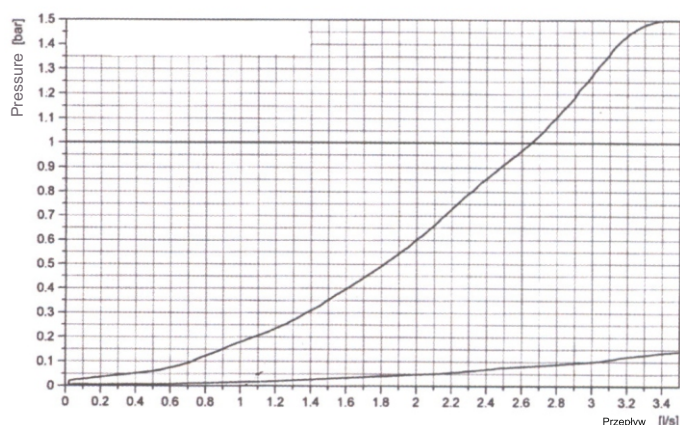

Type	Cod.
Ball valve BIOFLUX 1/2" with filter	100001
Ball valve BIOFLUX 3/4" with filter	100002
Ball valve BIOFLUX 1" with filter	100003
Ball valve BIOFLUX 1 1/4" with filter	100004
Ball valve BIOFLUX 1 1/2" with filter	100005

Other products in our offer

(all products can be found in our price list)



Valves with actuators

**3-way
balanced valves**



**Cast iron butterfly
with actuator**



**Flange mixing valves. Thermostatic mixing valves for:
domestic warm water, underfloor
heating systems**

3F / 4F



TMT



Thermo



Heating controllers, thermostats

Lago



E8



Pump units with plate heat exchanger

BW



Solar units

VERTIGO R 90



VERTIGO VRD 90



MAVERICK VRD 90



OTHER PRODUCTS

GENERAL CONDITIONS OF SALE

§1. Introduction.

1.1. The sales contracts entered into by WOMIX. (hereinafter the „seller“) while conducting its business activities are governed by these general terms and conditions, unless there are exceptions resulting from an explicit written agreement and expressly approved in writing by the Sales Office of the seller.

1.2. Any terms and conditions of the buyer and in particular conditions of purchase, will not apply to the relationships between the parties unless expressly accepted in writing and approved in the same form by the Sales Office of the seller: in this case, however, unless waived in writing, these terms and conditions still remain in effect.

1.3. The possible invalidity of one or more provisions of these general conditions of sale will not affect the validity of the contract as a whole.

1.4. These general conditions of sale are considered to be fully read and accepted by the buyer upon order placement.

§2. Formation of the contract and its execution.

2.1. Orders taken or commitments made by representatives, agents or other collaborators of WOMIX cannot bind the seller in any way; it follows that all orders processed by the aforementioned representatives, agents and collaborators become valid and effective only upon written confirmation from the seller and the written approval by the Sales Office of the seller.

2.2. Any changes to the order will be effective only upon written confirmation and written approval by the Sales Office of the seller.

§3. Purpose and prices.

3.1. The data, measurements, articles, prices, features, performance and all other data shown in our catalogues, price lists, prospectuses, circulars etc. are given only as indications; they may be changed without any warning and are only considered binding for the seller in the event of their explicit mention in the acceptance or confirmation of the order.

3.2. The price lists of the seller are not offers; they are only approximate and may be modified unilaterally by the seller without notice.

3.3. The prices are considered to be standard, unless otherwise agreed, „ex-works of the seller“, packaging excluded. Fees, taxes and duties in force at the time of delivery are the responsibility of the buyer. Prices do not include services or charges not mentioned.

3.4. Insurance expenses for the goods are to be borne by the buyer, as well as any expenses and customs duties due to delays in custom clearance or other reasons.

§4. Payments.

4.1. Barring written exceptions, all payments must be made at the offices of WOMIX in Euro.

4.2. Payment for the goods is made in the form of a prepayment.

4.3. The date of payment shall be the date the influence of the amount indicated on the invoice VAT on the Seller's bank account.

§5. Delivery and transfer of risk.

5.1. The seller will notify by letter or telegram or telefax or e-mail or certified mail (certified email address) that the goods are available to the buyer at the seller's premises.

5.2. The delivery of material is considered „free on board“. The responsibility of the seller stops with delivery to the buyer or carrier; consequently the material is transported at the risk of the buyer. In cases in which, due to specific buyer interventions, the material is sold „free delivery“, no disputes will be accepted for any thefts, damages or tampering. Any agreements with forwarding agents, including the amount and payment of the cost of transportation are considered settled in the name of and on behalf of the buyer who, from that moment onward, accepts and approves the conduct of the seller.

§6. Transport and packaging.

6.1. The cost of transporting material from the seller's premises to the place of destination is normally intended to be borne by the seller, unless otherwise agreed in the order confirmation. Transport costs are, in any case, to be borne by the buyer. The buyer assumes all risks inherent in the transportation starting from the delivery of the goods to the shipper or carrier, even if the right to property is reserved.

6.2. The seller will provide the packaging according to the rules of use. The seller is exempt from any liability for loss or damage which does not result from intentional or gross negligence by the seller and is not the direct and immediate consequence of its conduct. For specific types of packaging, the extra amounts indicated in the price list or in the order confirmation will be included in the invoice.

6.3. Any transport costs are determined individually, depending on the number, type and weight of the shipment.

§7. Testing and warranty.

7.1. Unless otherwise stated, supplies by the seller are regulated by the rules and details contained in the WOMIX catalogue.

OTHER PRODUCTS

7.2. All the products of the seller are carefully tested on site; they are therefore covered by a warranty for a period of two from the date of issue of the invoice.

7.3. The seller's warranty is limited to pure and simple replacement of the defective part, which must first be returned to the seller (and therefore any expenses, damages, interest or compensation of any kind are strictly excluded from the warranty). In any case, the components produced by the seller recognised as being faulty, preceded by a complaint made by the buyer within the maximum time period set forth by existing regulation, will be replaced only by the seller. Nevertheless the liability of the seller is limited to faults which appear under normal working conditions and during correct product use.

7.4. Any damage caused by incorrect product operation must be made known within 24 hours, providing the name of the damaged part and the approximate amount of the damage. Subsequently photographs showing the damage must be sent, together with the product which caused the alleged damage, for examination in the laboratory. Anything which may provide evidence of the extent of the damage must be made available to the seller until the case is closed.

7.5. The seller refuses all responsibility for any damage or injury to persons, animals or property derived from the use of the appliances without observing the safety provisions or from appliances which are not installed correctly and/or were installed without performing the appropriate operation checks.

§8. Terms of delivery and return of goods.

8.1. The terms of delivery go into effect on the day following that on which the agreement is reached on each element of the contract and all information necessary for execution is received by the seller. In any case it is understood that the terms of delivery specified in the seller's offers only serve as guidelines and are not binding.

8.2. If an import licence is requested from the country of the buyer, the delivery terms will go into effect from the moment the seller has been informed in writing of the granting of the licence.

8.3. The seller assumes no responsibility for any delays in delivery. Deliveries of goods, even if partial, cannot be refused by the buyer; partial deliveries of goods do not give the buyer the right to cancel the order.

8.4. No liability will be due to the seller, and therefore nothing will be due to the buyer, if the delay is not attributable to the seller - as in the case of delays by third parties, including suppliers and subcontractors, due to force majeure such as demonstrations, riots, strikes or lockouts, wars, epidemics, closure, accidents or failures of machinery or tools, fires, collapses, floods, earthquakes, extreme temperatures, weather events and generally in any other case involving partial or total inactivity of the premises of the seller and production stoppage or slowdown.

8.5. In any case, the buyer cannot use the delay in delivery to terminate the contract.

8.6. Except as provided for in number 8. on the subject of warranty, the client cannot for any reason return delivered material without the express written permission of the seller. To obtain consent for return and be entitled to a refund of the purchase price already paid, the buyer must return the material as follows:

- the material must be unused and returned in the same condition in which the buyer received it;
- the material must be returned within fifteen days (15) of the date of the invoice;
- the material must be returned to WOMIX - at the expense and risk of the buyer - to the headquarter in Poland, 89-200 Szubin ul. Sportowa 31

§9. Withdrawal and suspension of supply.

9.1. In case of unforeseen circumstances, force majeure and fortuitous events (such as but not limited to strikes or lockouts, missed or reduced supply of raw materials, difficulty of transport, wars, insurrection, interruption of communications, however caused, plant breakdowns etc.) the seller has the right to withdraw from this agreement and/or suspend the current supply when these unexpected events, wherever they take place, substantially alter the state of the markets, the value of money, Polish industry conditions or circumstances arise, even endogenous, that according to the incontestable judgement of the Seller, do not allow for the useful continuation of the supply relationship.

9.2. In any case, under these general conditions of sale regarding withdrawal from the contract and/or suspension of the supply of material, the buyer will not be entitled to reparation, compensation, reimbursement or damages.

§10. Intellectual property rights.

Any drawing or technical document related to products of the seller, even if given to the buyer, remains the exclusive property of the seller and cannot be used by the buyer or copied, reproduced, transmitted or communicated to third parties without the prior written authorisation of the seller.

§11. Complaints.

11.1. The buyer is required to examine the goods carefully when it receives delivery and notify the seller within five (5) days from the delivery/receipt, of any defects or quality issues found in the product.

11.2. Any complaints and/or disputes about defects or quality issues of the product do not give the buyer the right to omit or delay payments of the supply.



womix

Comfort Controls

**We are able to make a product tailored to the customer's needs.
If you have any questions, please contact the office.**

WOMIX
Sportowa 31
89-200 Szubin
tel. +48 52 382 44 50
fax +48 52 382 44 51



www.womix.pl



www.facebook.com/WomixPolska



export@womix.pl

All declarations, mounting instructions and pricelist can be found on website www.womix.pl

**Womix is not responsible for mistakes, which may be in this price list. Womix reserved the right to change technical parameters of products.
Product images may differ from actual.**